

T. 10 S., R. 6 W., W. M.

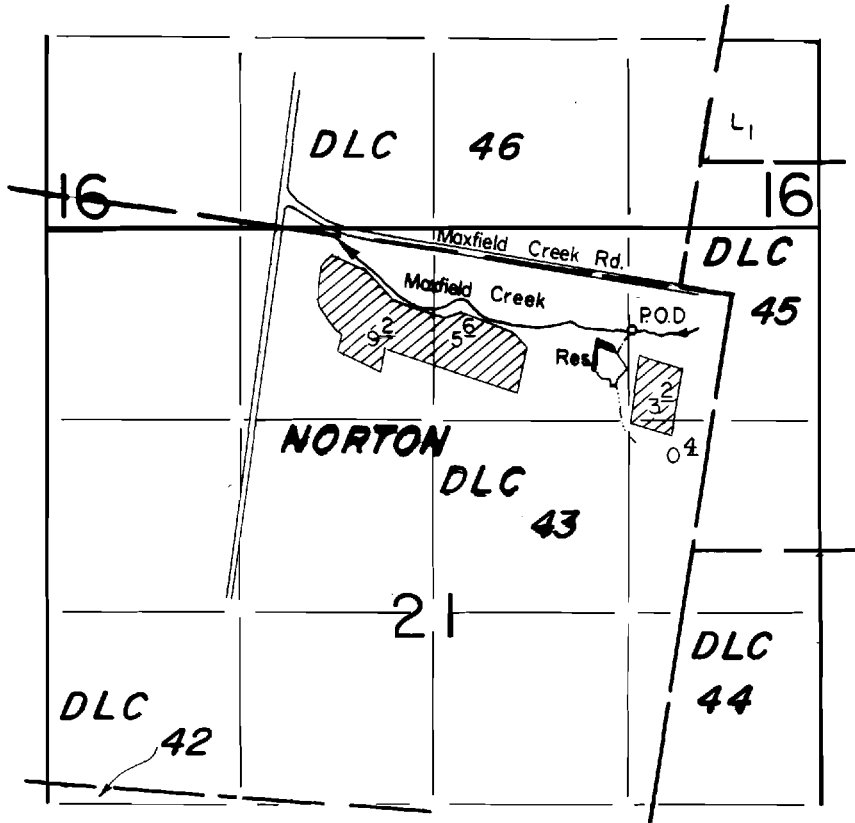

P.O.D. Loc. : 200' S. & 700' W. from NE Cor. DLC 44.  
 RES. LOCs - 350' S. & 900' W. from NE Cor. DLC 44

Scale: 1" = 1320'

**FINAL PROOF SURVEY**  
 UNDER

R-58626                      R-7929

Application No. 58627 Permit No. 44383.....

IN NAME OF

**PATRICK M. MALONE**

Surveyed April 28, 1987, by J. Warren.....

PTS-1987-A  
 DFJ-3LL-01  
 3/6/89 TAW