

T. 4N., R. 27E., W.M.

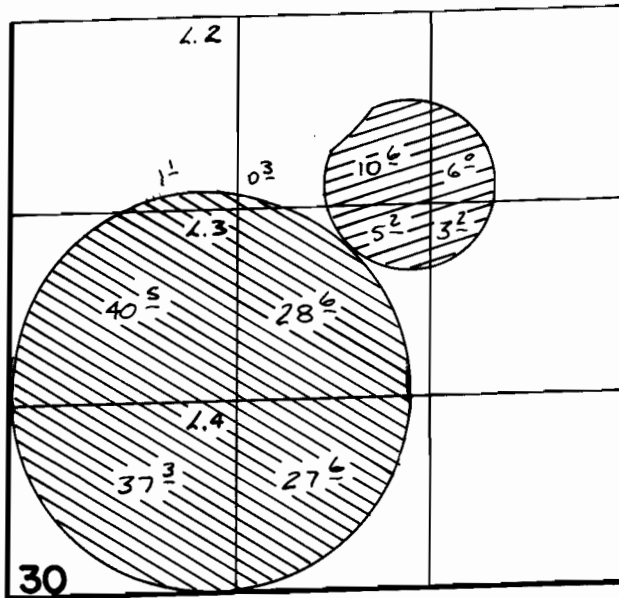

T. 4N., R. 25E., W.M.

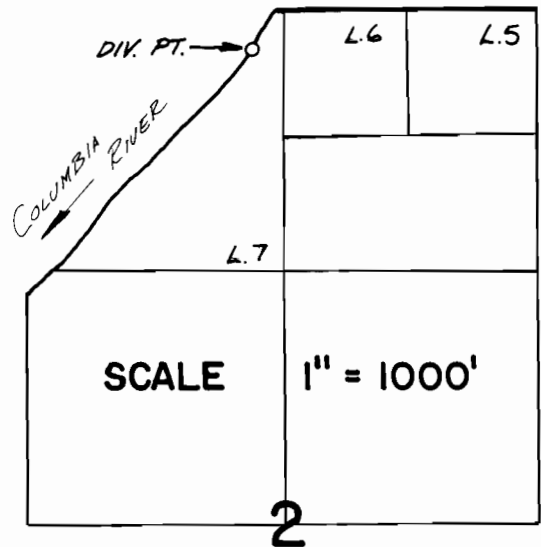

 PRIMARY  SUPPLEMENTAL

DIV. PT. LOC: S. $86^{\circ}22'46''$ W. 2811.00 FT. FROM NE. COR. SEC. 2

FINAL PROOF SURVEY

UNDER

Application No. **61318** Permit No. **45590**
IN NAME OF

STARR - WOOD FARMS

Surveyed April 2, 1982, by V.L. Church