

T.13 S., R. 31 E., W.M.

APPLICATION MAP FOR

ANNOLA ASHCRAFT

Application No. 63846  
Permit No. 47008

NW1/4 SE1/4 SEC. 35 T.13S. R.31E. W.M.  
GRANT COUNTY

POD is located  
360 ft S &  
470 ft E of  
center 1/4 corner  
Section 35  
T13S, R31E, WM

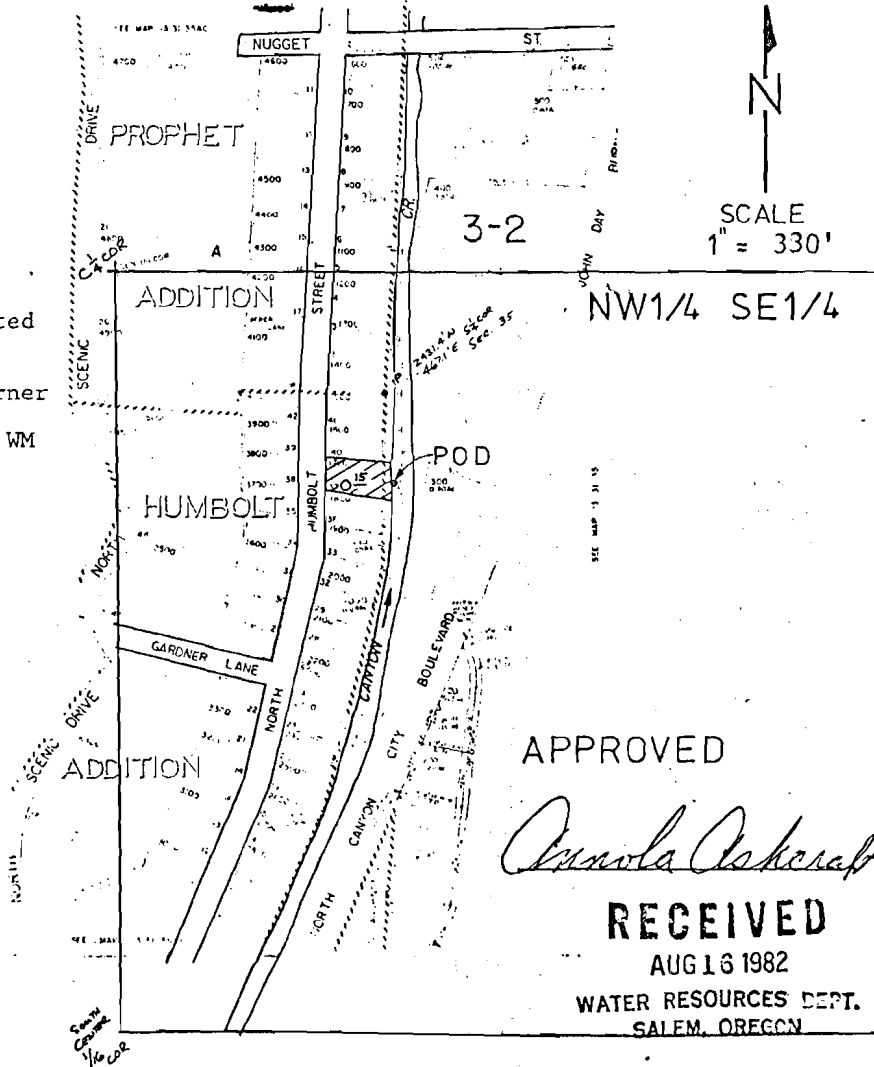

APPROVED

*Annola Ashcraft*

RECEIVED

AUG 16 1982

WATER RESOURCES DEPT.  
SALEM, OREGON