

T. 10S., R. 5W., W.M.

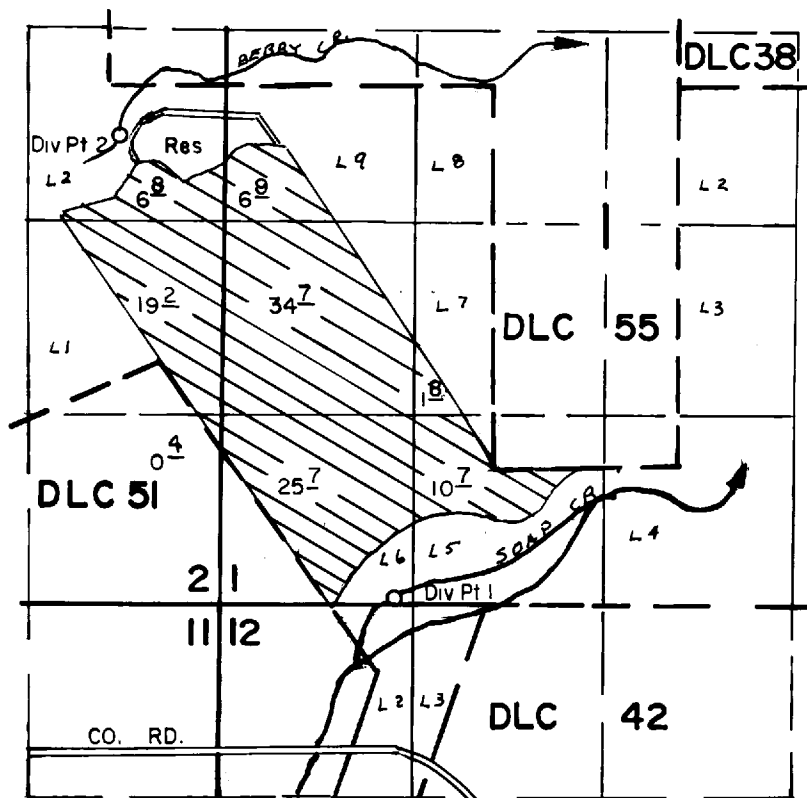

Div Pt 1 Located 50' N & 1200' E, Div Pt 2 Located 3200' N & 750' W,
Both From The SW Corner Section 1.

SCALE: 1" = 1320'

FINAL PROOF SURVEY UNDER

R-59512 R-8167

Application No. 5.9513.... Permit No. 45016.....

IN NAME OF

GYLAN MULKEY

Surveyed MAY 5, 1987, by B.W.BISHOP.....