

T. 2 S. R. 39 E. W.M.

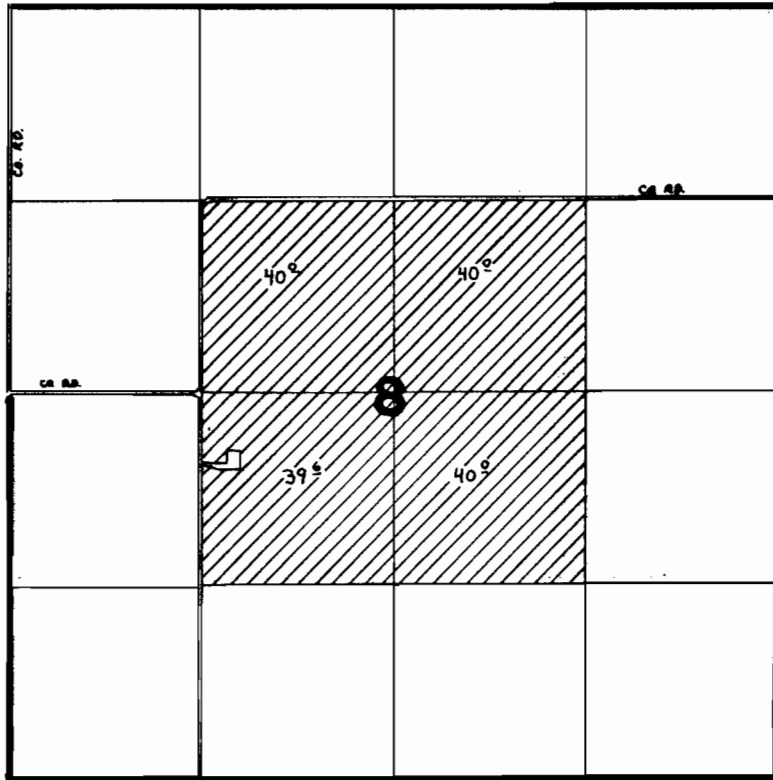
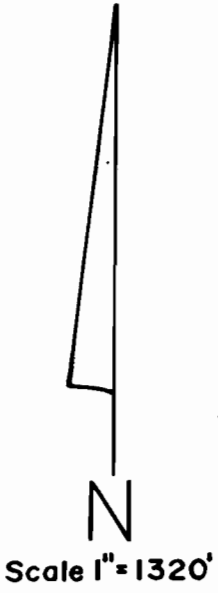

FINAL PROOF SURVEY UNDER

Application No. 62766.. Permit No. 46594.....

IN NAME OF

.....**CRESTON J. SHAW**.....

Surveyed April...2... 1987., by V. Church.....

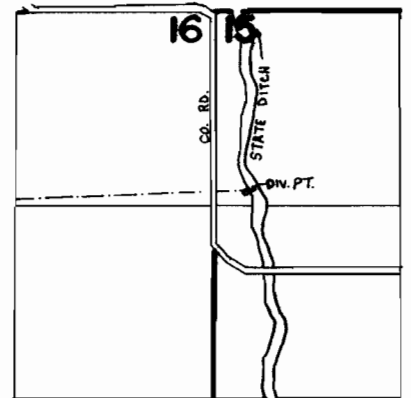

DIV. PT. LOC. 1250' S. of 230' E. FROM NW COR. SEC. 15