

T.5&6S., R.5W., W.M.

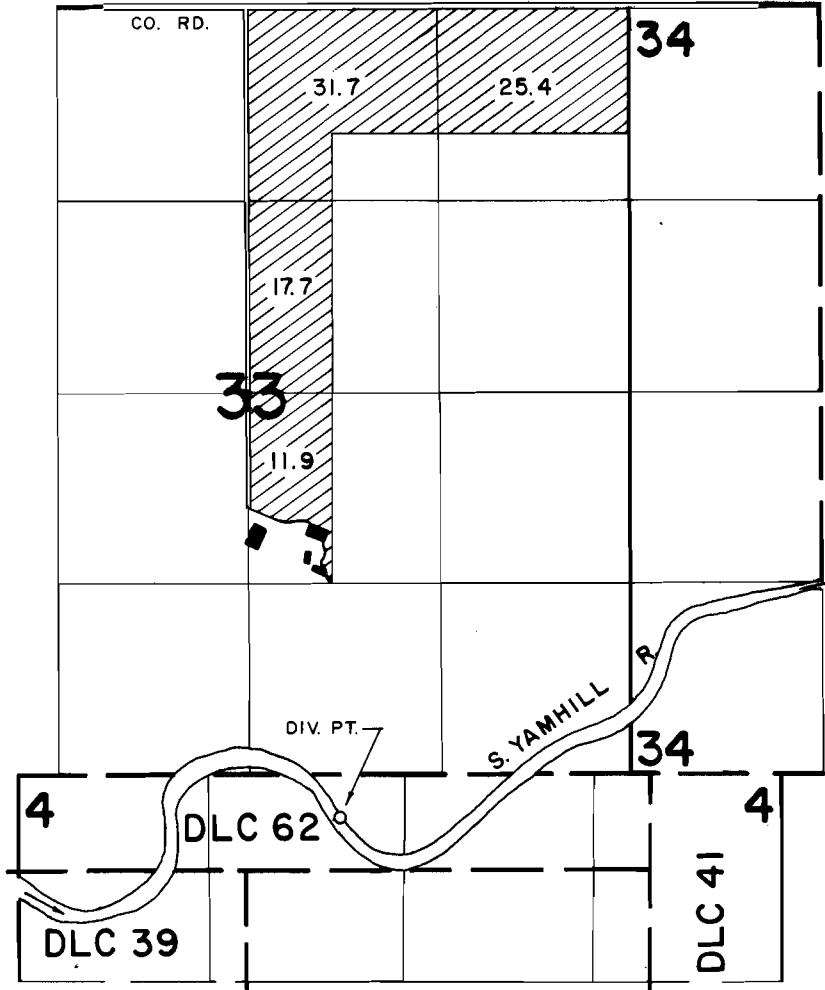

DIV. PT. LOCATION: 300 FT. S. & 660 FT. E. FROM THE S. 1/4 CORNER OF SECTION 33

FINAL PROOF SURVEY UNDER

N

SCALE: 4" = 1 MILE

Application No. 63229 Permit No. 47202
IN NAME OF

JOHN DeJONG

Surveyed OCT. 2, 1984, by P. P. Patten