

# T1S., R.2W., W.M.

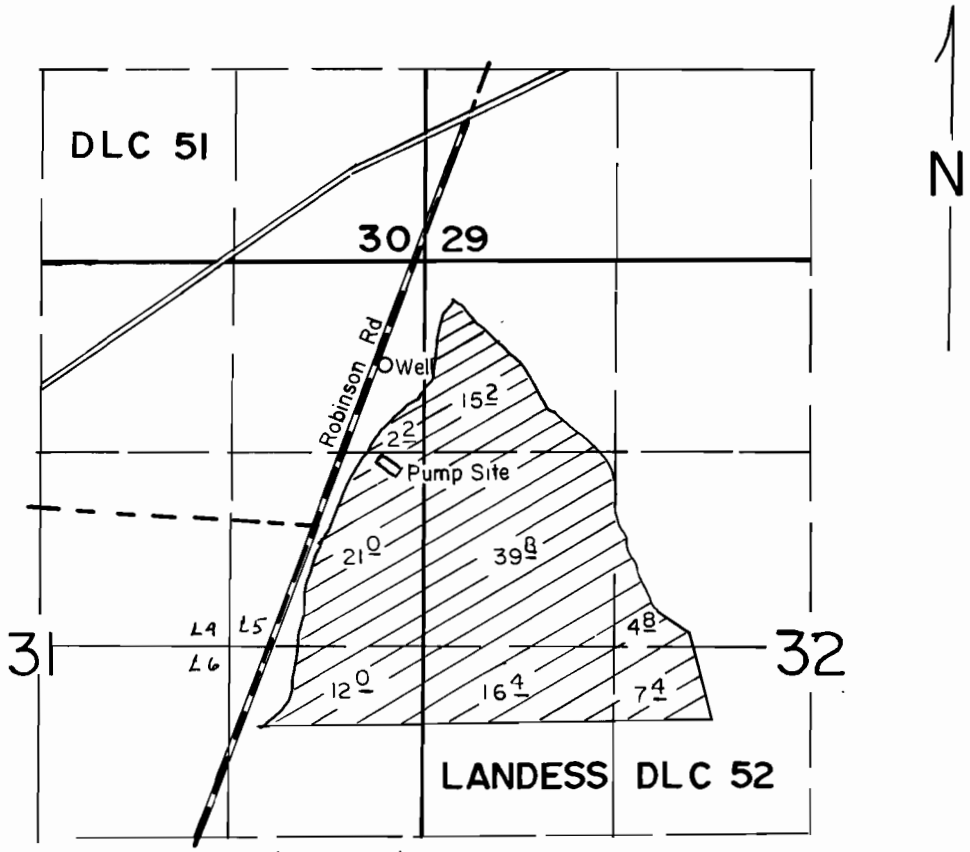

Well Located 700' S. & 250' W. From N.W. Corner Section 32

SCALE: 1"=1320'

## FINAL PROOF SURVEY UNDER

Application No. G-9458. Permit No. G-8861.....  
IN NAME OF

.....**WILFORD J. KALSCH**.....

Surveyed **JULY 21**, 19**86**, by **B.W. BISHOP**.....