

T14S, R5W, WM

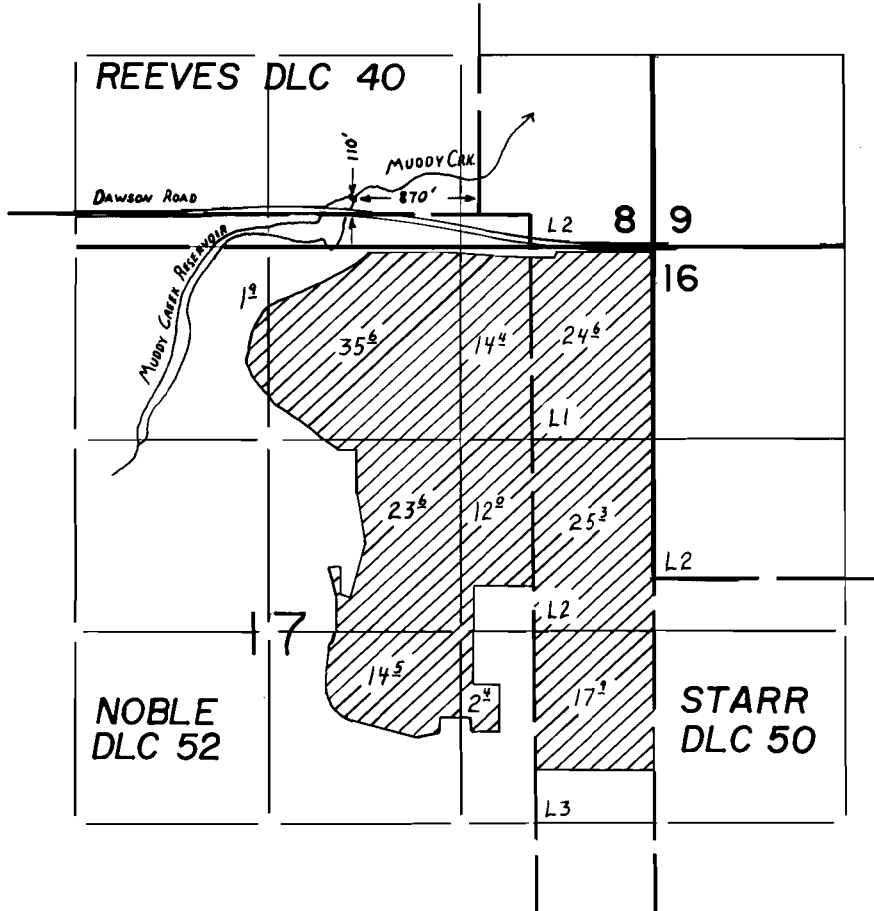

FINAL PROOF SURVEY UNDER

R-56447 R-6886
 Application No. 56448 Permit No. 42763.....

IN NAME OF
MILTON E. & DEBRA SEDLACEK
REX V. & JOANNE SEDLACEK

Surveyed NOV. 18, 1987, by T. M. WARREN...