

T. 5 & 6 N. R. 35 E. W.M.

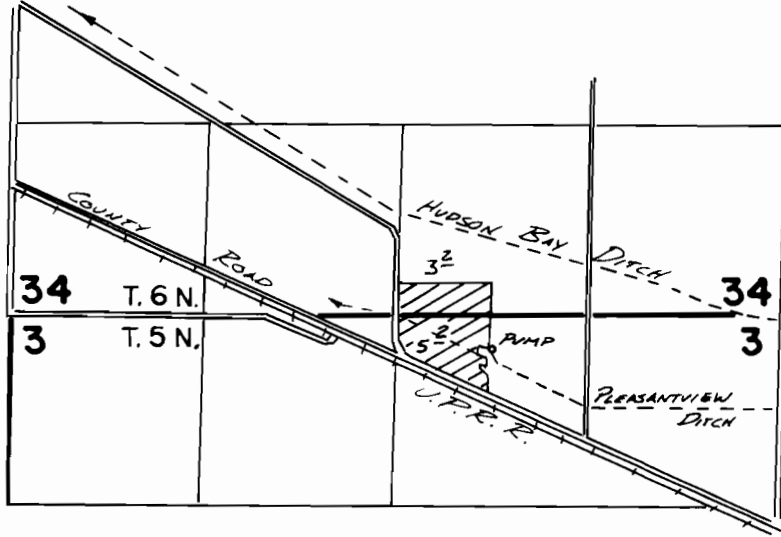

Scale 1"=1320'

T. 5 N., R. 35 E. W.M.

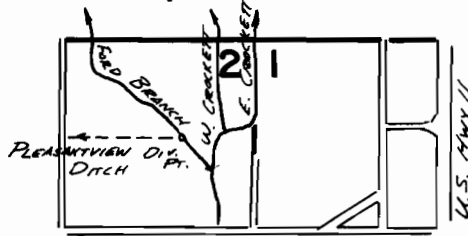

Div. Pt. Loc. 670'S & 500'W. FROM NE COR. SEC. 2

FINAL PROOF SURVEY

UNDER

Application No. **52735** Permit No. **39710**....
IN NAME OF

.....**RAY CARTER**.....

Surveyed JUNE 6... 1982., by V. CHURCH.....