

T.5S., R.6W., W.M.

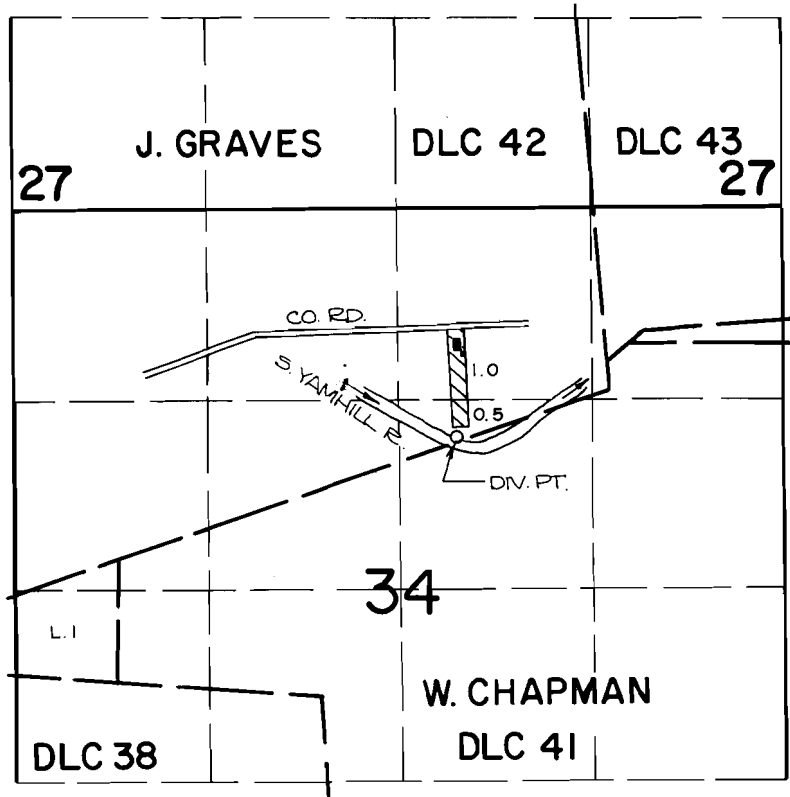

DIV. PT. LOCATION: 1560 FT. S. AND 400 FT. E. FROM THE N. 1/4 CORNER OF SECTION 34.

FINAL PROOF SURVEY UNDER



Application No. 54883.. Permit No. 41162.....
IN NAME OF

SCALE: 4" = 1 MILE

Surveyed OCT. 30., 1984., by *P. Patten*