

T.6S., R.39E., W.M.

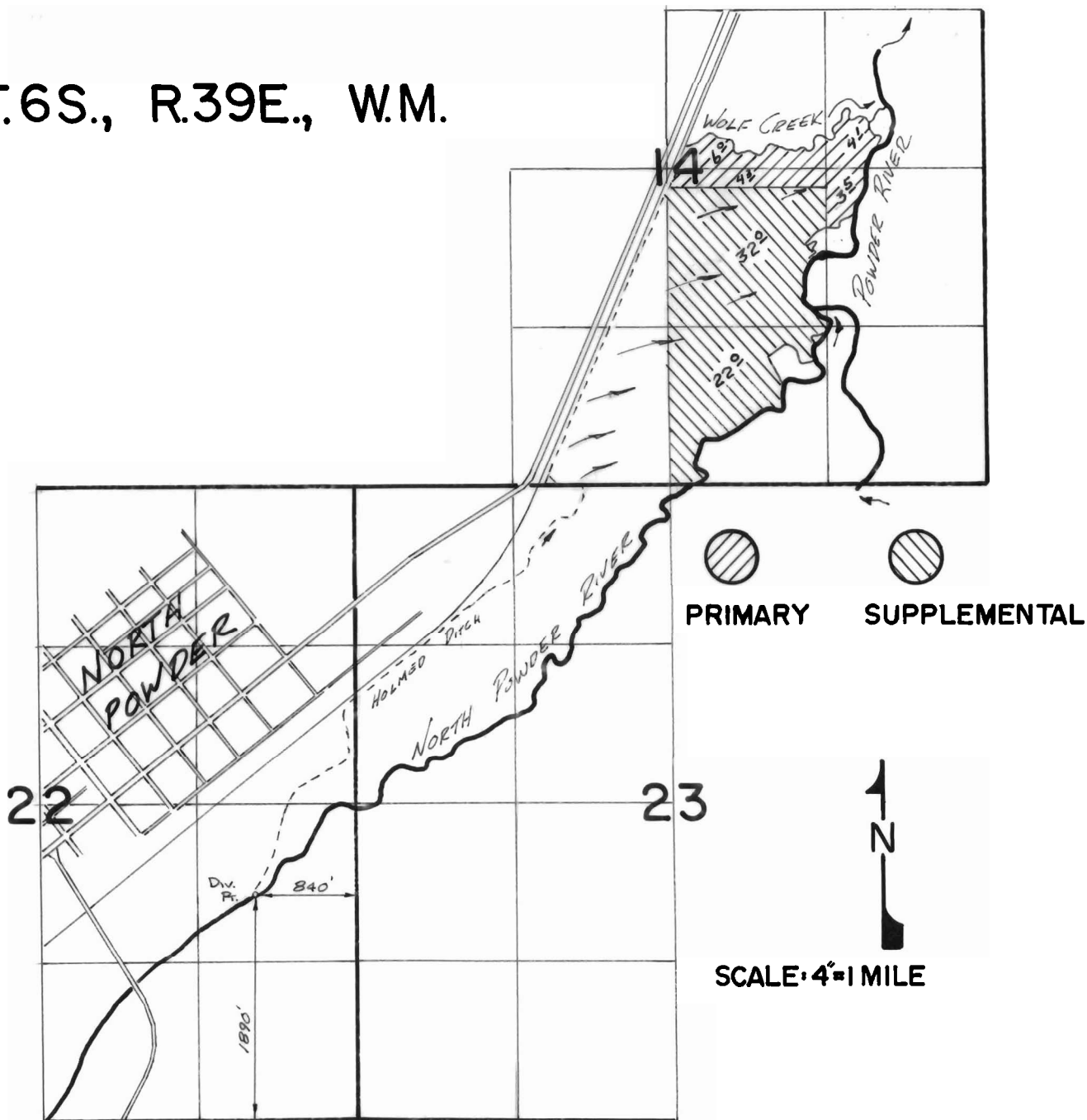

DIV. PT. LOCATED 840' WEST AND 1890' NORTH FROM SEC. COR

FINAL PROOF SURVEY UNDER

Application No. 61091..... Permit No. 45715.....
IN NAME OF

..... DON D. DODSON

Surveyed NOV. 20..... 1981..... by V.L. CHURCH.....