

RECEIVED

AUG 3 1981

WATER RESOURCES DEPT
SALEM, OREGON

RECEIVED

FEB 5 1982

WATER RESOURCES DEPT
SALEM, OREGON

T27S R11W
Section 18
NE 1/4 NW 1/4



SCALE:
1" = 200'

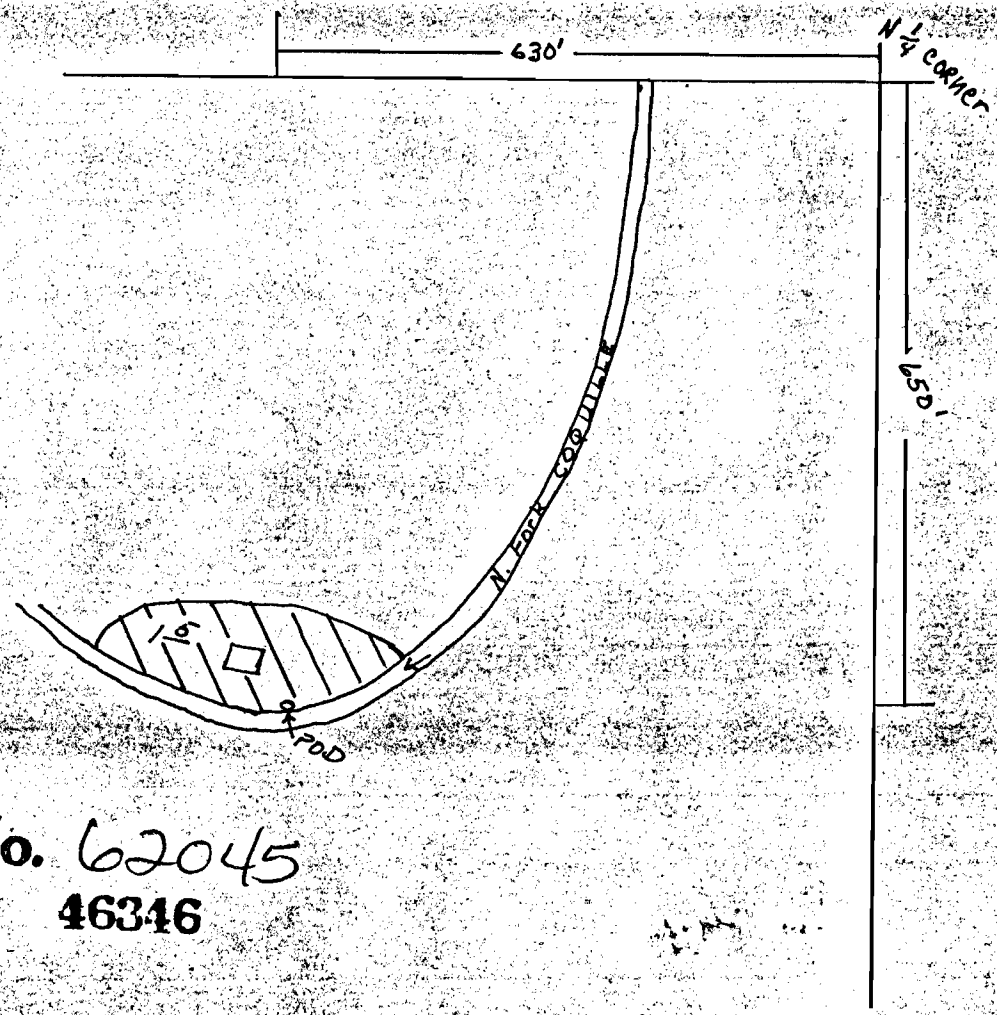

Application No. 62045
Permit No. 46346