

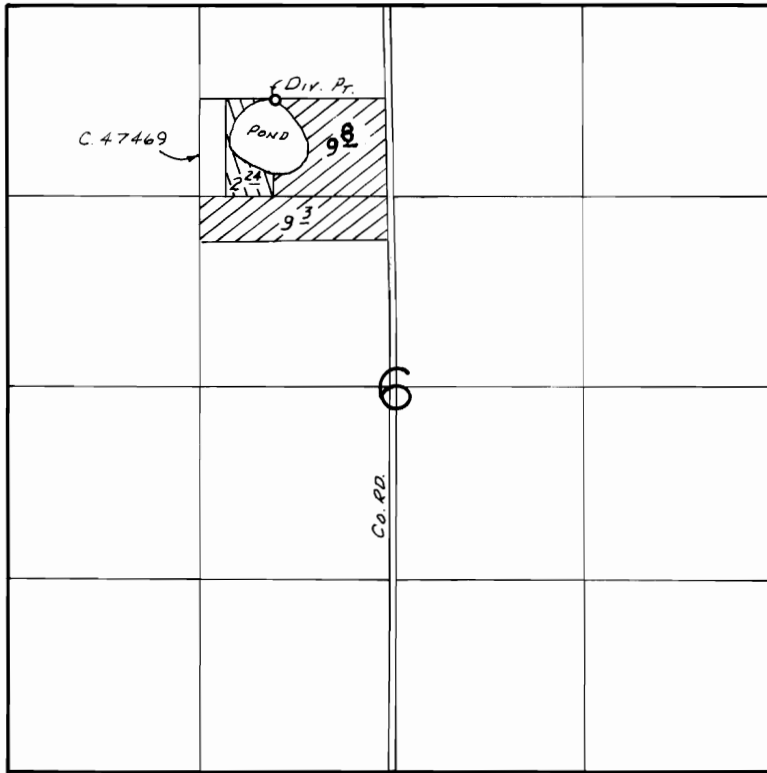

T. 41S., R. 19E., W.M.



Div. Pt. Loc.: 660'S. & 1850'E. FROM NW COR. SEC. 6.

SCALE: 1"=1320'

FINAL PROOF SURVEY UNDER

Transfer No. 4555 

Application No. 60929.. Permit No. 46200. 

IN NAME OF

.....LEO DUMILIEU.....

Surveyed June 25, 1984, by B.W. BISHOP.....