

T. 1S., R. 2W., W.M.

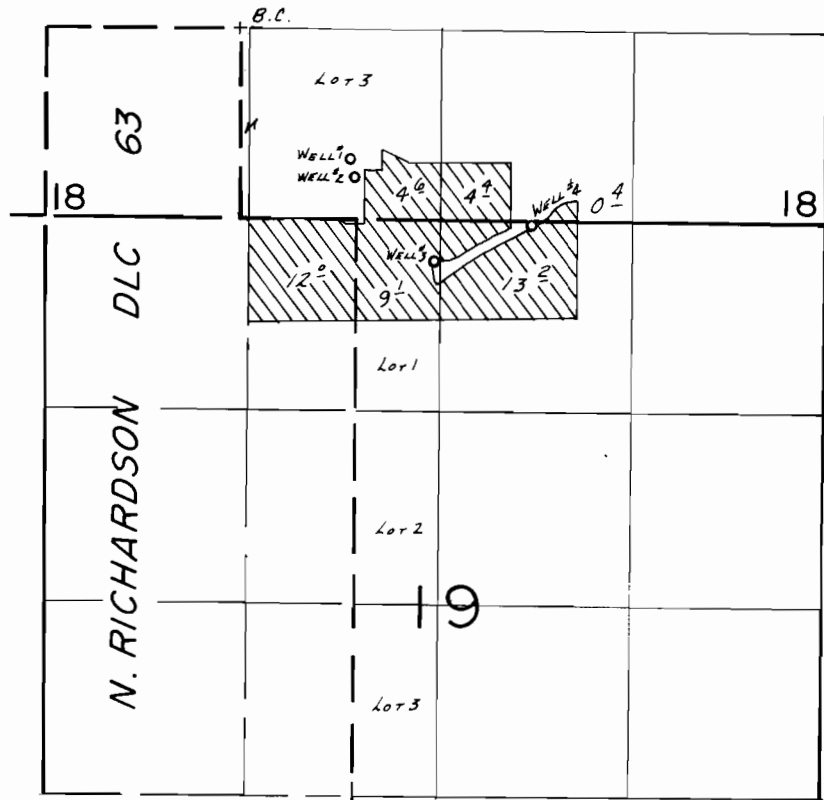

WELLS LOC.: #1-900'S. & 760'E., #2-1010'S. & 790'E., #3-1580'S. & 1340'E., #4-1340'S. & 2000'E. ALL FROM NNE COR. RICHARDSON DLC 63.

SCALE: 1" = 1320'

FINAL PROOF SURVEY UNDER

Application No. ~~G-7906~~ Permit No. ~~G-8141~~.....
IN NAME OF

OREGON BERRY PACKING COMPANY

Surveyed July 23, 1986, by B.W. BISHOP.....

2-5-87
BWB