

T. 3 S., R. 1 W., W. M.

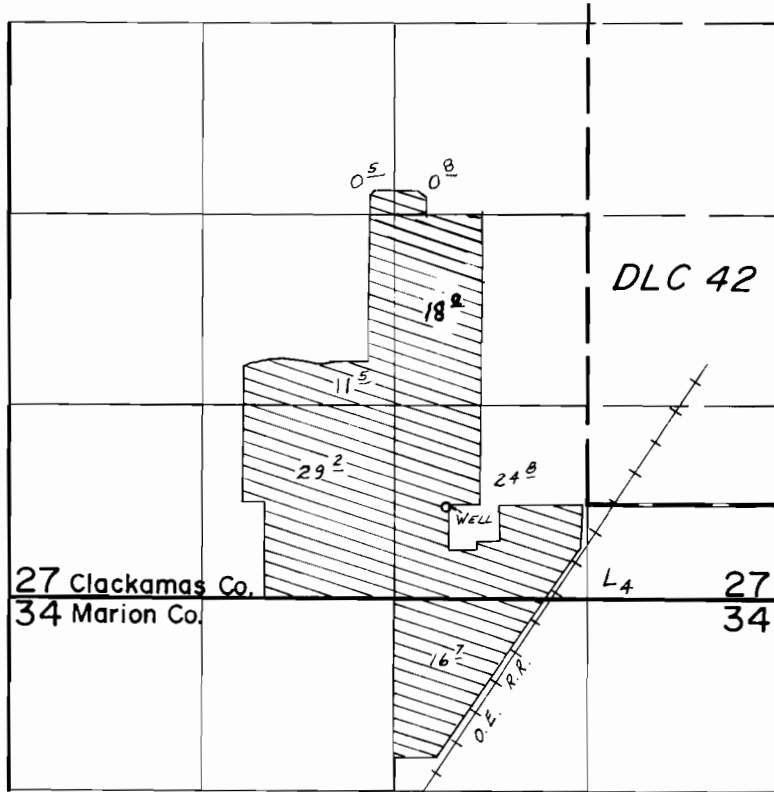

WELL LOC: 640' N. & 350' E. FROM THE S. 1/4 COR. SEC. 27.

SCALE: 1" = 1320'

FINAL PROOF SURVEY
UNDER

Application No. G-8006. Permit No. G-8535.....
IN NAME OF

.....**JOE CASALE & SON, INC.**.....

Surveyed AUG. 14, 1984, by B.W. BISHOP.....