

G 8963
62466

T. 6 N. R. 35 E. W. M.

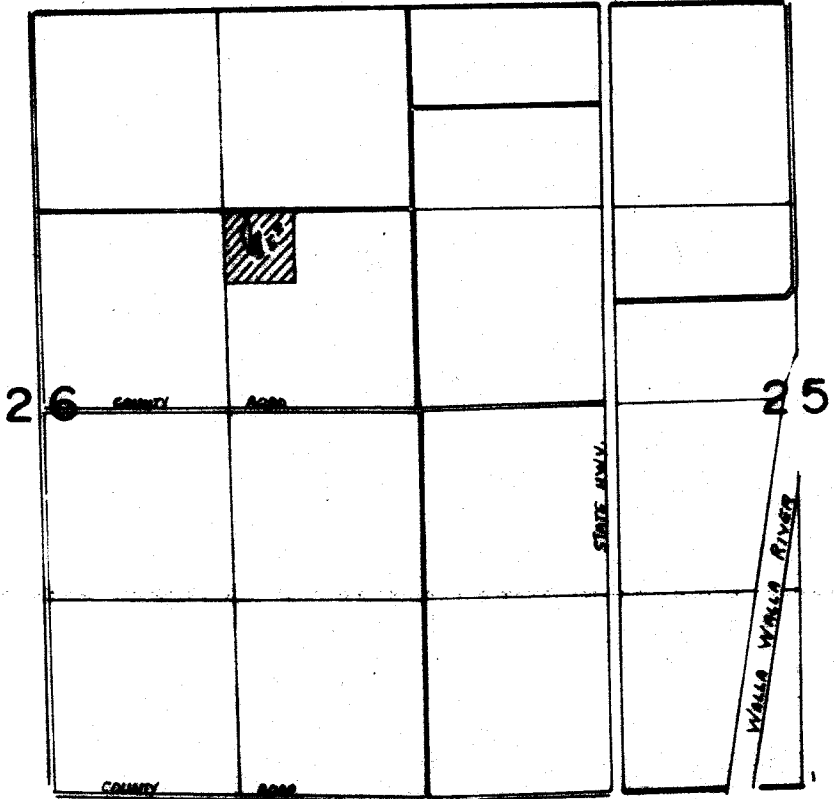

WELL LOCATED 1650' SOUTH AND 1100' WEST FROM N.E. COR. SEC. 26

FINAL PROOF SURVEY UNDER

SCALE 1" = 1320'

Application No. G-8564 Permit No. G-8263
IN NAME OF

WAYNE M. TRUMBULL

Surveyed 4-30 1927, by V.L. CHURCH