

T. 23 S., R.32 1/2 E., WM.

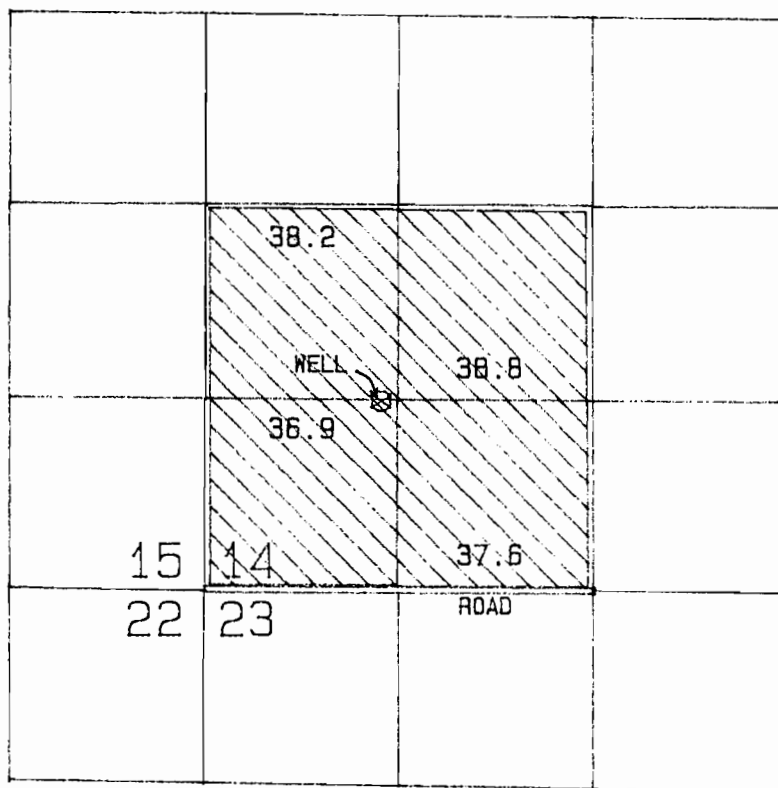

WELL LOCATED: 1310 FT NORTH AND 1190 FT EAST FROM THE
SOUTHWEST CORNER OF SECTION 14

SCALE 1 IN = 1320 FT

FINAL PROOF SURVEY
UNDER

APPLICATION NO.: G-9871

PERMIT NO.: G-9060

MELVIN V. DAVENPORT

SURVEYED JULY 15, 1986

BY: DON CLARK

C.A.D. : TMW

PHOTO 41025-179-33L