

G-9050

62475

T. 13S., R. 32E. W.M.

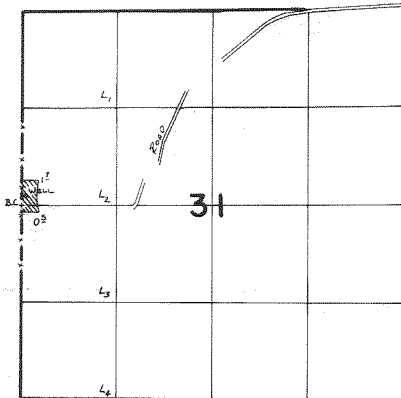

Well loc: 140' N. & 50' E. From W 1/4 Cor. Sec. 31

**FINAL PROOF SURVEY**  
UNDER

Application No. **G-9902** Permit No. **G-9050**  
IN NAME OF

**CATHERINE VILLALOBOS**

Surveyed **3-12** 19**86**, by **J. M. Tall**