

Form OR-010-7300-2
4/83

UNITED STATES
DEPARTMENT OF THE INTERIOR
BUREAU OF LAND MANAGEMENT

RECEIVED R-9451
62593
SEP 8 1983
LAND RESOURCES DEPT.
SALEM, OREGON

Section

5, 6, 7, 8

Township 40S

Range 11E.

Appl. No. R-65875

Permit No. R 9451

Will. Mer.

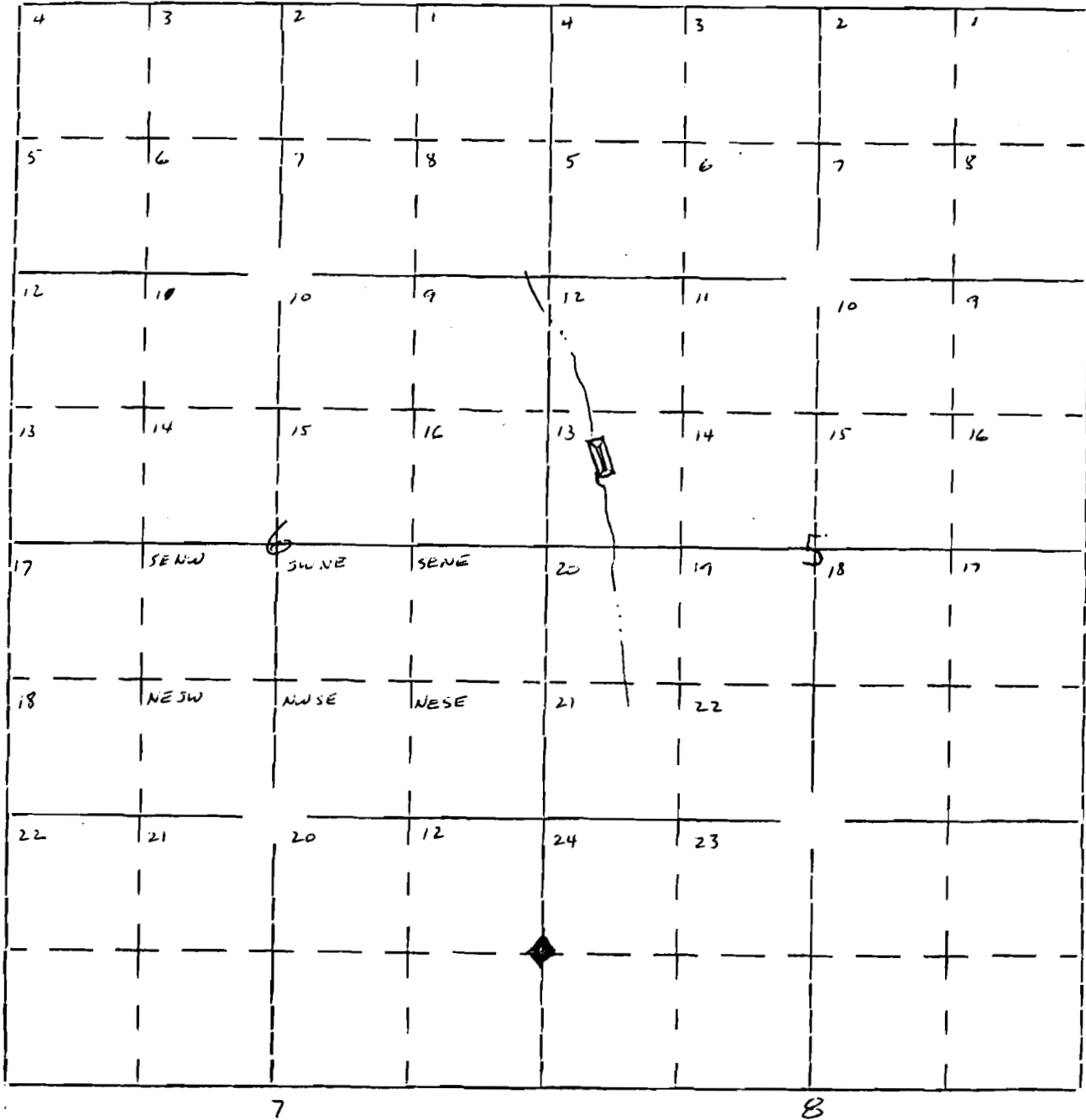

Project is located 4,374' north and 250' east of corner common to sections 5, 6, 7 & 8.