

T.5S., R.3W., W.M.

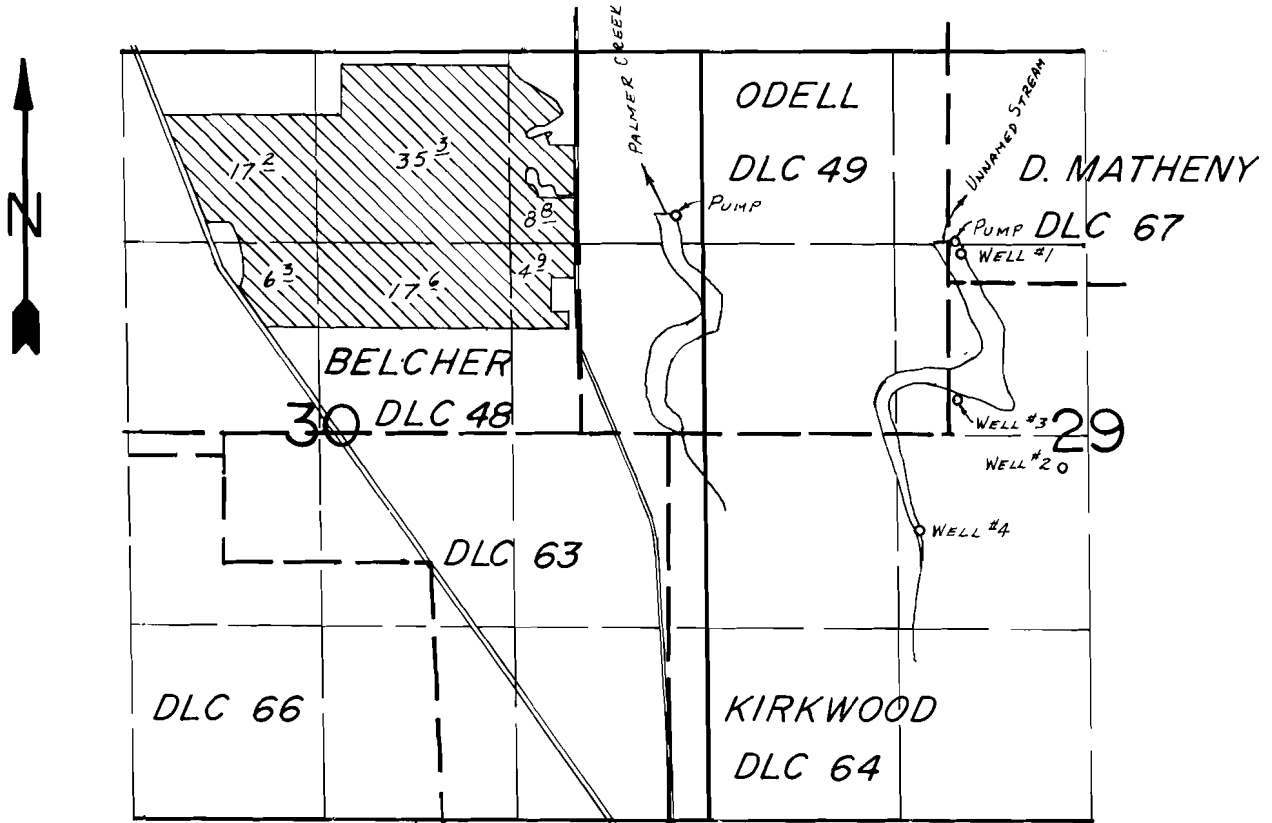

WELLS LOC.: #1- 1400'S. & 1700'E, #2- 2860'S. & 2450'E, #3- 2400'S. & 1740'E, #4- 3290'S. & 1470'E, DIV. PTS. LOC.: WESTERLY- 1100'S. & 250'W, EASTERLY- 1300'S. & 1650'E, ALL FROM NW COR. SEC. 29.

SCALE: 1" = 1320'

**FINAL PROOF SURVEY**  
UNDER

G-9214                      G-8823  
Application No. 58581... Permit No. 44780.....  
IN NAME OF

.....ROBERT L. JANZEN.....

Surveyed Sept. 5..... 19.85, by B.W. BISHOP.....