

T. 9&10S., R. 6W., W.M.

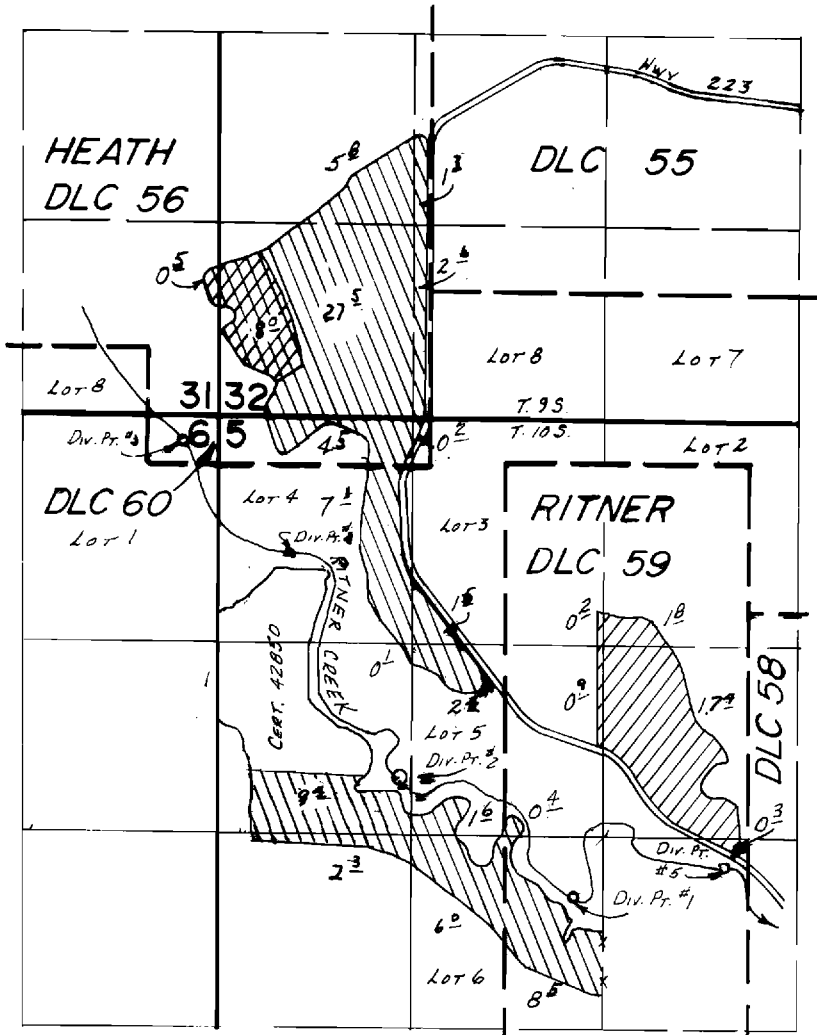

Div. Pts. Located; No 1, 4150'S & 950'E No 2, 3350'S & 230' W No 3, 1040'S & 1700'W No 4, 1820'S & 950' W No 5, 3920'S & 2000' E All From SW Corner DLC 55, Section 32

SCALE: 1" = 1320'

FINAL PROOF SURVEY
UNDER

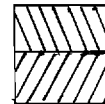

Permit 40173
Permit 43240

53815 40173
Application No. 55300... Permit No. 43240.....
IN NAME OF

.....HENRY R. KAISER.....

Surveyed Aug. 7..... 1984, by L.M. TOLL.....

7-25-84
DM
DFP-344-179
41053-178-99R
BWB