

T. 9&10S., R. 6W., W.M.

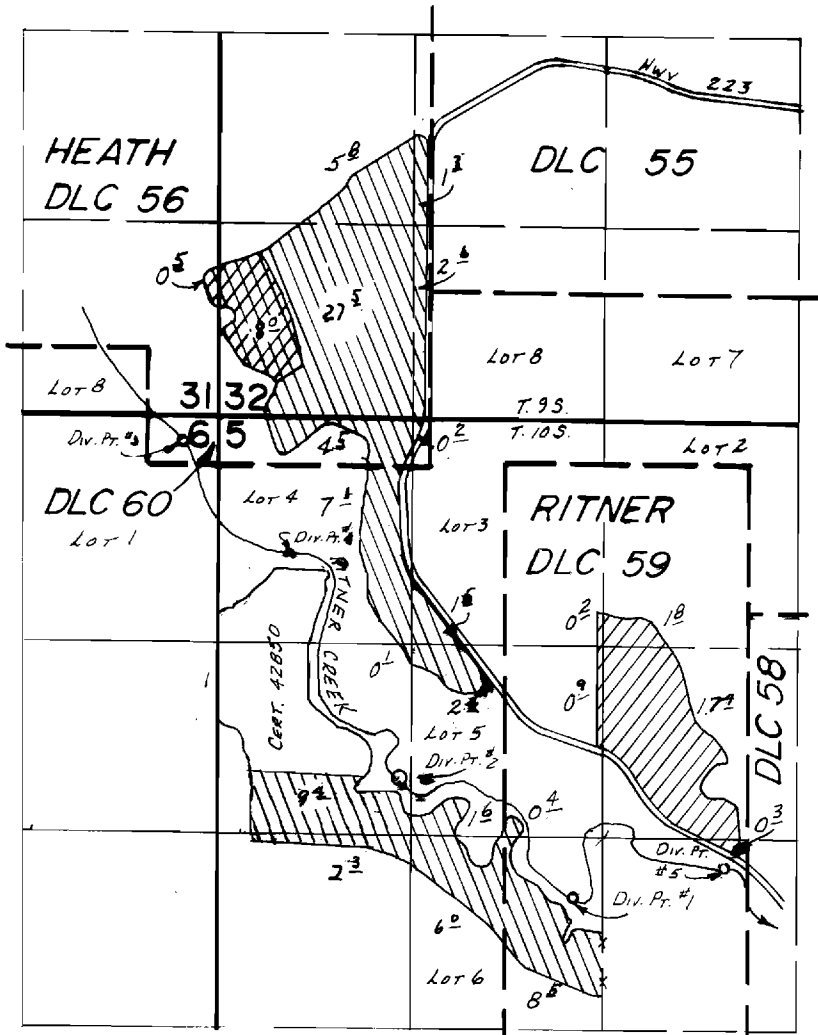

Div. Pts. Located; No 1, 4150'S & 950'E No 2, 3350'S & 230' W No 3, 1040'S & 1700'W No 4, 1820'S & 950'W No 5, 3920'S & 2000'E All From SW Corner  
DLC 55, Section 32

SCALE: 1" = 1320'

**FINAL PROOF SURVEY**  
UNDER

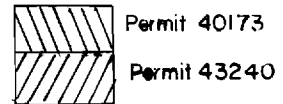

53815                      40173  
Application No. 55300... Permit No. 43240.....  
IN NAME OF

.....HENRY R. KAISER.....

Surveyed Aug. 7, 1984, by L. M. TOLL.....

7-25-84  
DM  
DFP-3LL-179  
41053-178-99R  
BWB