

T.2S. R.12&13E. W.M.

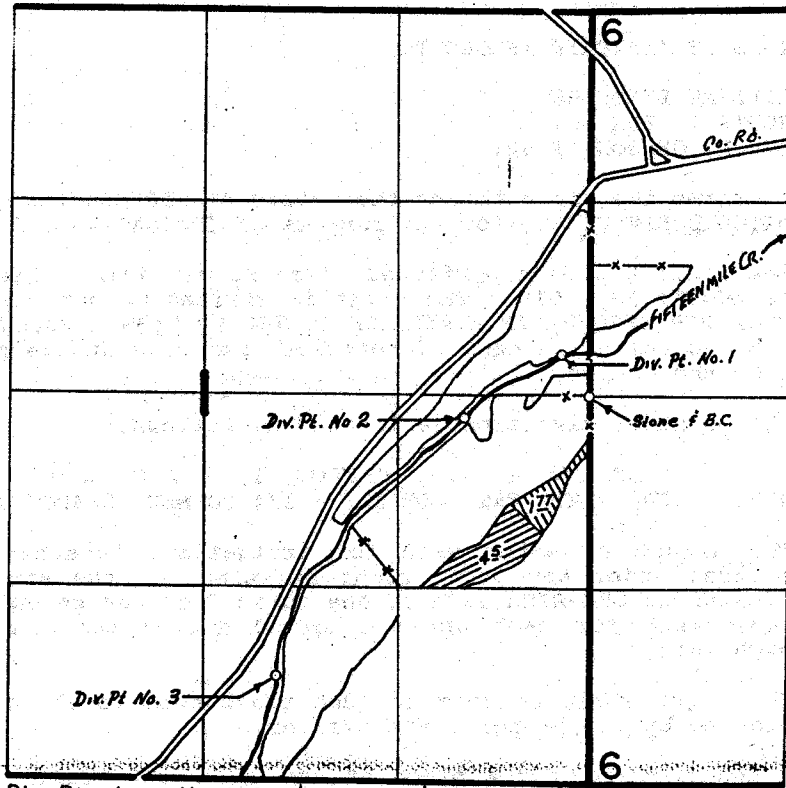

Div. Pts. Loc. No. 1 290' N. & 200' W., No. 2 150' S. & 870' W.,
 No. 3 1910 S. & 2170' W. All From The E1/4 Cor.
 Sec. 1

	TRANSFER	3892
	TRANSFER	3893

FINAL PROOF SURVEY UNDER

Application No. _____ Transfer Nos. 3892, 3893, 3894, & 3895
 Permit No. _____
 IN NAME OF
 _____ LILLIAN LINDHORST _____
 Surveyed May, 6, 1983, by T. J. Paul _____