

UNITED STATES
DEPARTMENT OF THE INTERIOR
BUREAU OF LAND MANAGEMENT

Dry Creek Res.
RECEIVED
NOV 20 1963
STATE ENGINEER
WALEN, OREGON

SECTION

Oregon State Water Filings

4

TOWNSHIP 325, RANGE 43 E, W. M.

North PINTO HORSE RESERVOIR

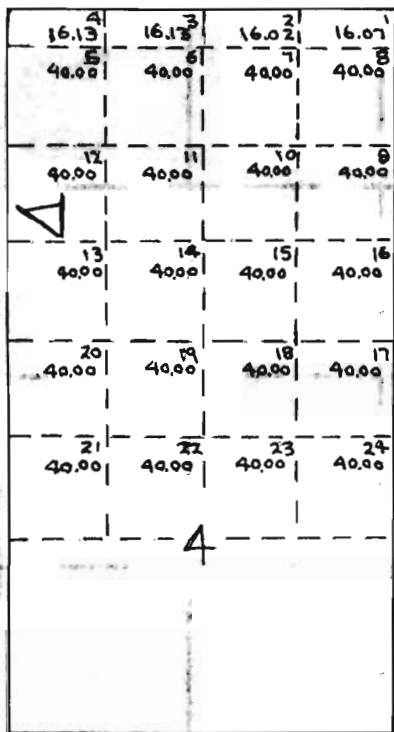

West

East

South

APPLICATION No. R-36643
PERMIT No. R-3795