

R-9254
63203

RECEIVED

UNITED STATES
DEPARTMENT OF THE INTERIOR
BUREAU OF LAND MANAGEMENT

SEP 28 1983
WATER RESOURCES DEPT.
SALEM, OREGON

SECTION 13
SE 1/4 NW 1/4

Oregon State Water Filings

TOWNSHIP 40S. RANGE 3E. W. M.

Application No. R-66705, 66706
Permit No. R 9254 48169

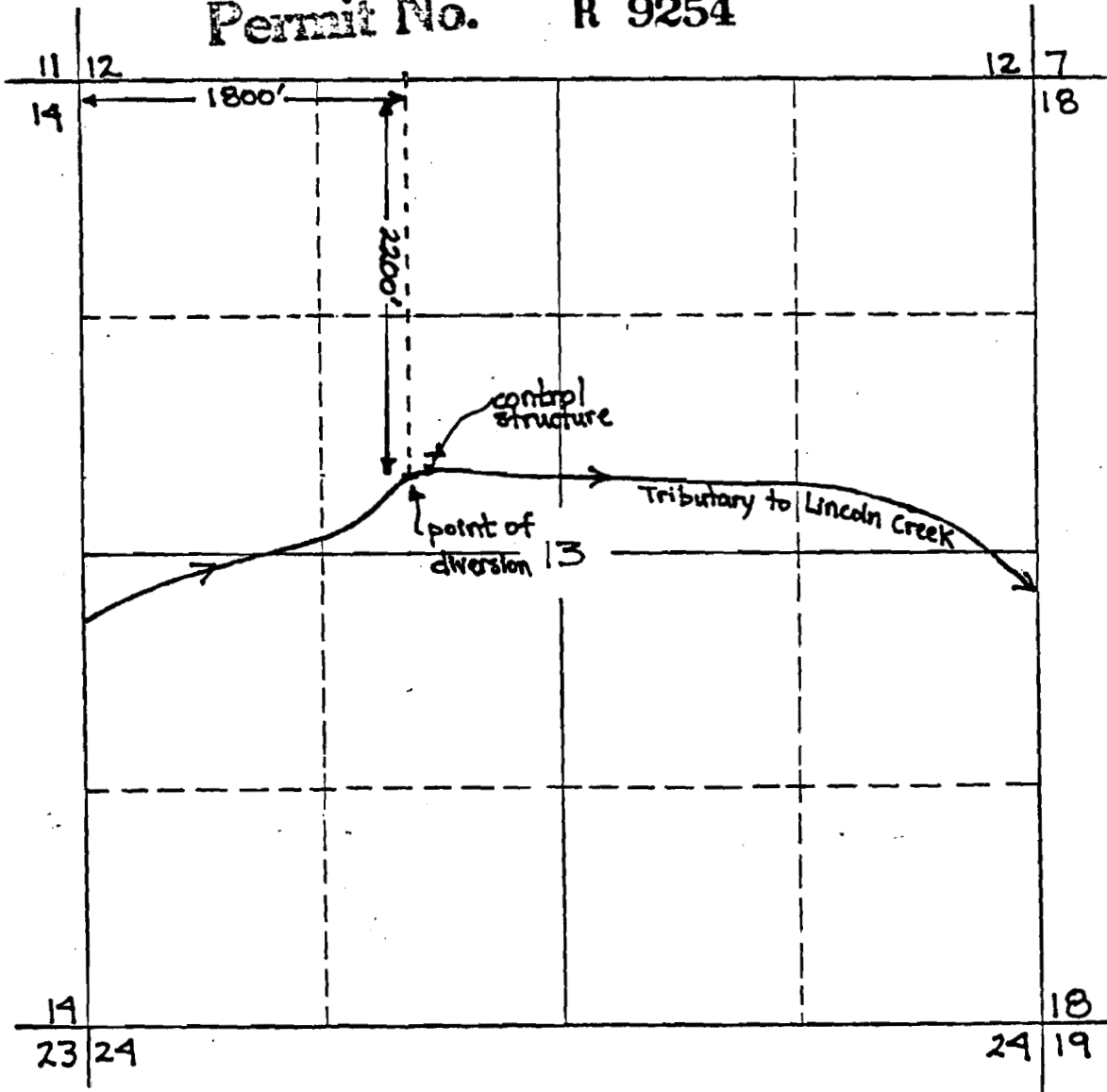

SCALE : 1" = 1000'

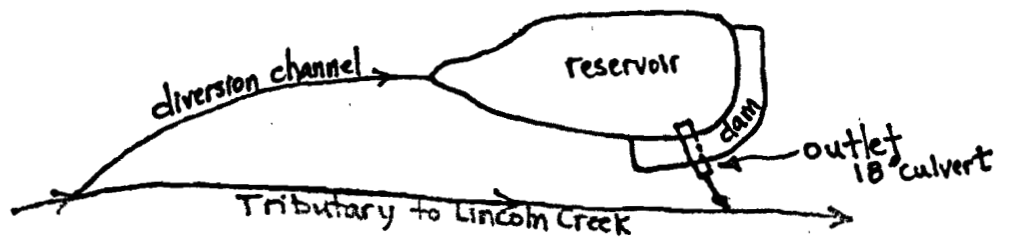

Point of Diversion & Reservoir