

R-9260
63209

RECEIVED

UNITED STATES
DEPARTMENT OF THE INTERIOR
BUREAU OF LAND MANAGEMENT

SEP 23 1983
WATER RESOURCES DEPT.
SALEM, OREGON

SECTION
21
SW 1/4 SW 1/4

Oregon State Water Filings

TOWNSHIP 38S., RANGE 5E., W. M.

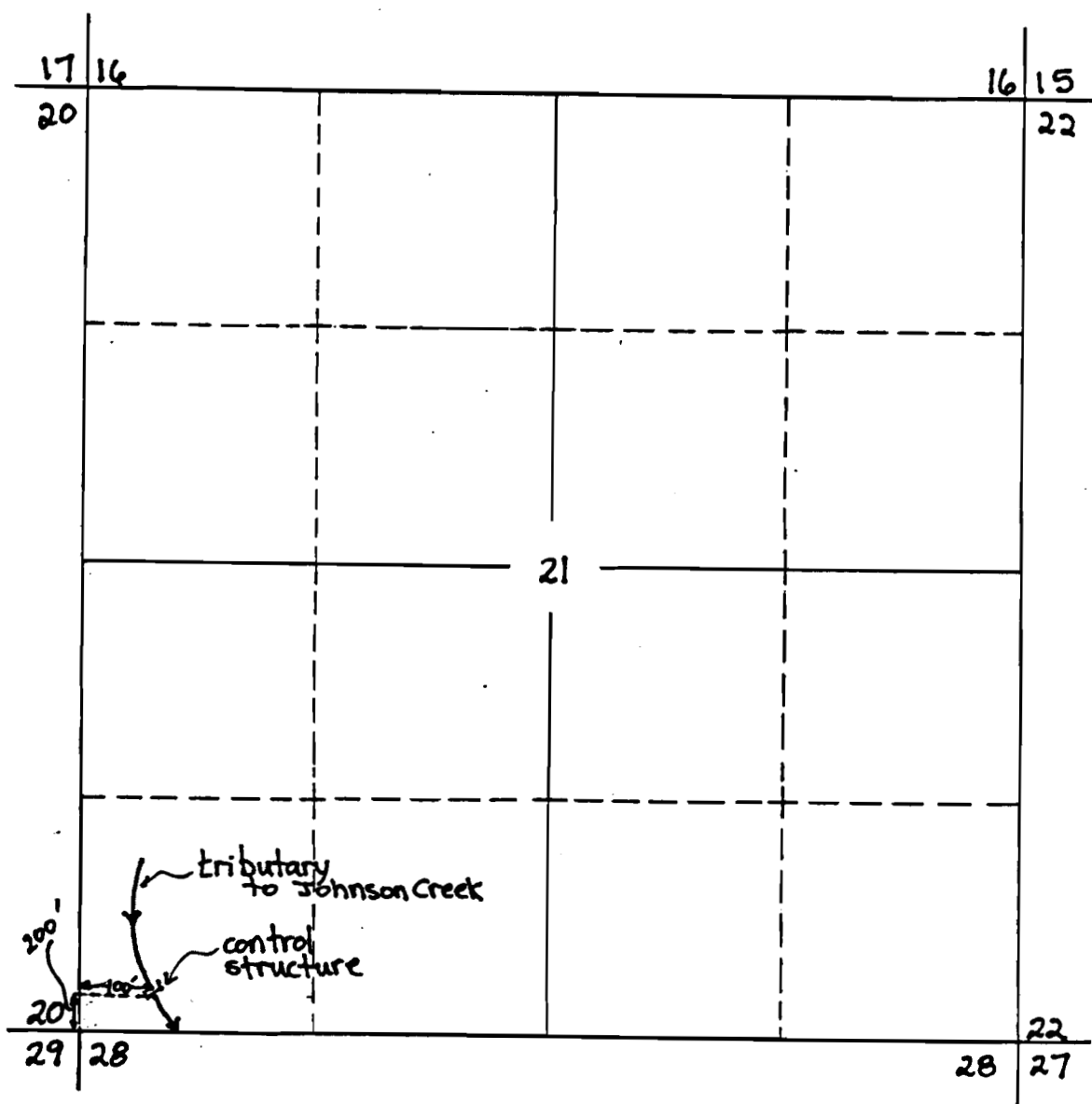

Jenny Ck. & Misc.

SCALE : 1" = 1000'

Application No. R-66714
Permit No. R 9260