

T.39S., R.20E.,W.M.

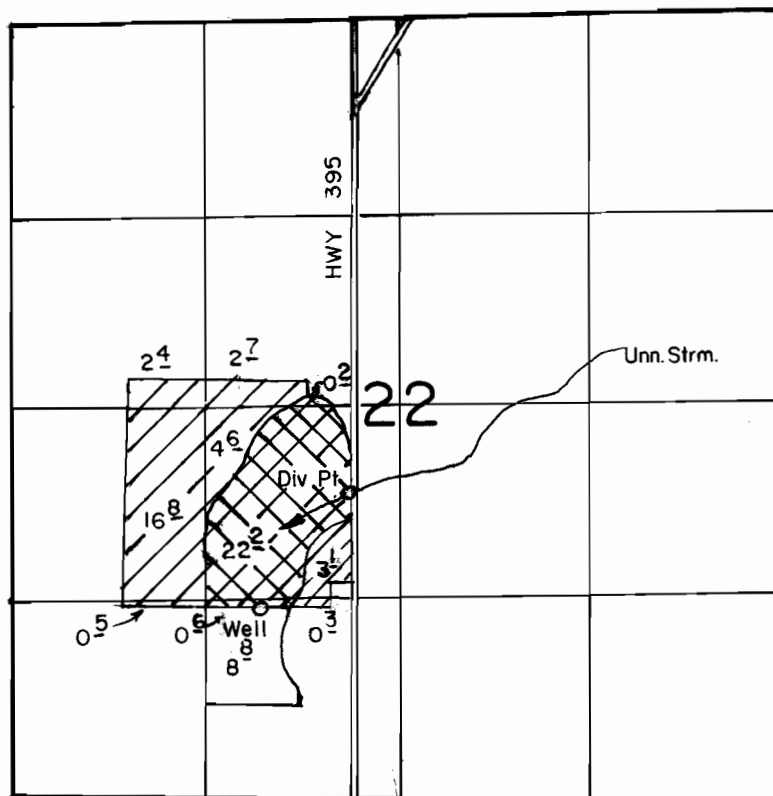

Well Located 1300' N & 950' W From S 1/4 Corner Sec 22
 Div. Pt. Located 2100' N & 350' W From S 1/4 Corner Sec 22

SCALE: 1" = 1320'

Permit 44573
 Permit G-8706

FINAL PROOF SURVEY
 UNDER

58680 44573

Application No. G-92.4.8.. Permit No. G-8706....
 IN NAME OF

..... **EDWIN L. DEPAOLI**

Surveyed OCT. 19. 1987., by V.L. CHURCH