

T. 34S., R. 6W., W.M.

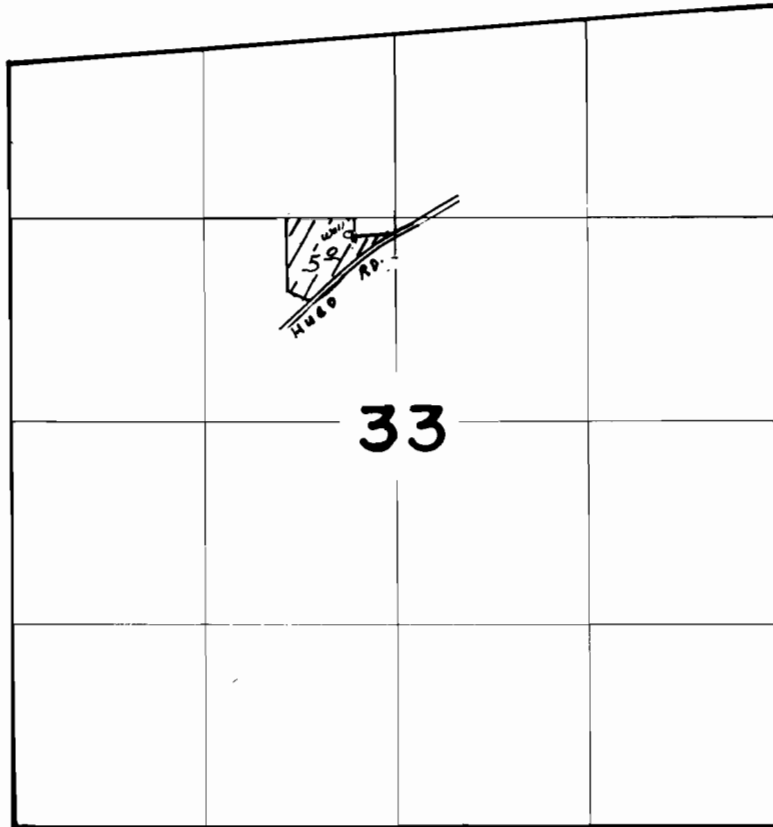

WELL: 1400'S & 200' W FROM N 1/4 COR. SEC 33

SCALE 1"=1320'

**FINAL PROOF SURVEY**  
UNDER

Application No. G.9317... Permit No. G.8740...  
IN NAME OF

.....LU. & THOMAS Mc QUINN.....

Surveyed SEPT. 11 1984, by J.R. WOODROOF