

T.31S. R.15W. W.M.

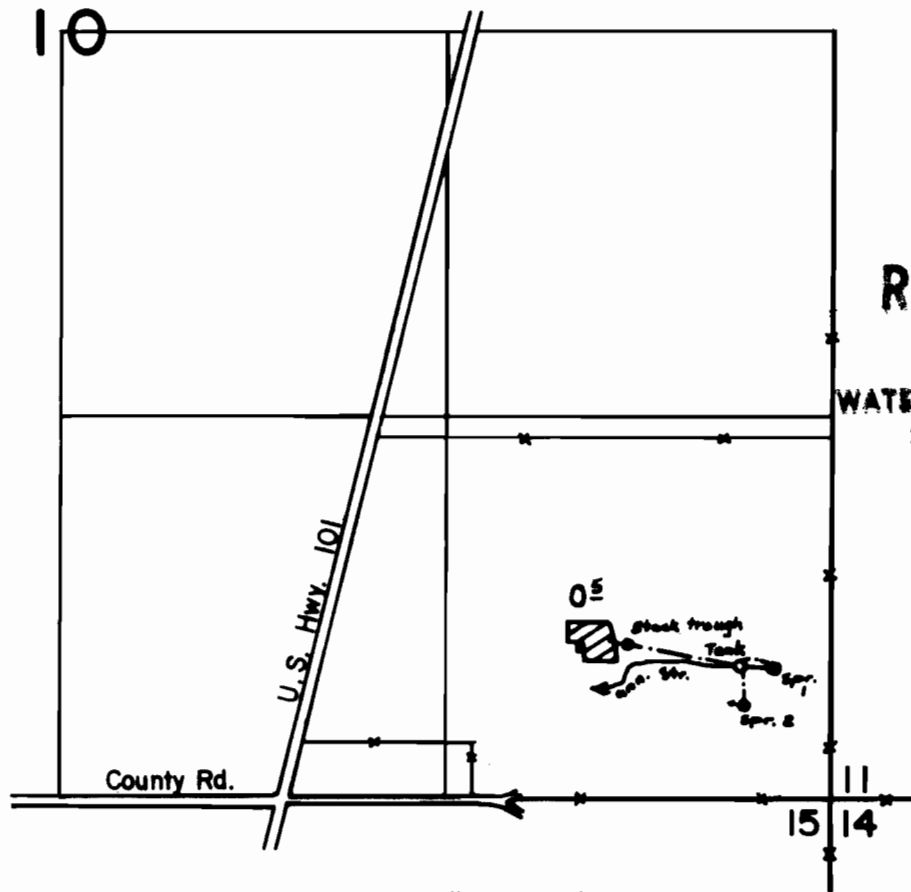

RECEIVED
 027 1978
 WATER RESOURCES DEPT.
 SALEM, OREGON

SCALE: 1" = 660'

SPRINGS LOCATED
 1 - 450' N | 190' W
 2 - 325' N | 300' W
 from SE COR SEC. 10

WATER RIGHT APPLICATION MAP
for

JACK and PATRICIA DONALDSON

Application No. 58206

Permit No. 43906