

STATE ENGINEER
RECEIVED

SEP 11 1922

SALEM, OREGON

MAP ACCOMPANYING APPLICATION
FOR PERMIT TO APPROPRIATE WATER FOR
DOMESTIC PURPOSES.

Scale 2"=1 Mi.

Robert H. Cram,
Gateway Ore.

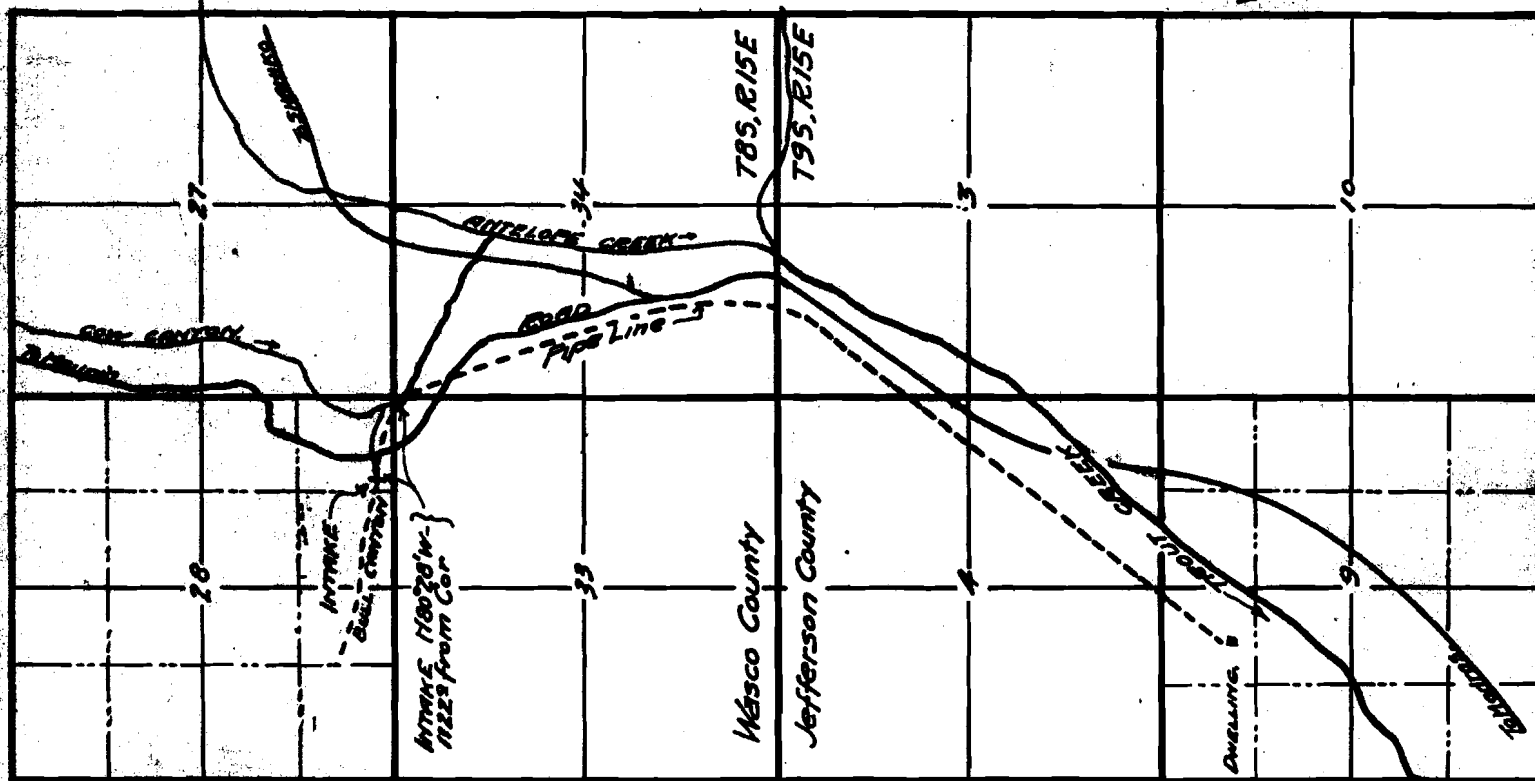

I, R.P. Newland, of Gateway, Ore., do hereby certify that this map was made from notes taken during an actual survey made by me on August, 19th, 1922, and that it correctly represents the works described in the accompanying application, together with the location of streams and other details in the vicinity.

R. P. Newland
Registered Professional Engineer.

Oregon No. 978.
Dec. 31, 1919.

Application No. 8634
Permit No. 5624

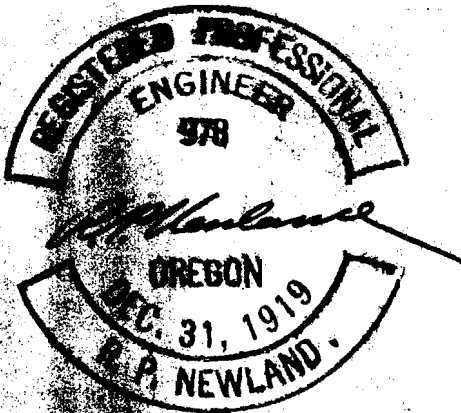

Handwritten initials 'R.C.' and 'e. ad.'

Handwritten number '5624'

Handwritten number '5624'