

STATE OF OREGON WATER RESOURCES DEPARTMENT  
 APPLICATION FOR A PERMIT TO CONSTRUCT A RESERVOIR

APPLICANT: USDA FOREST SERVICE, MT. HOOD NATIONAL FOREST

Township 4S Range 11E Section 35

Reservoir (Pond) Name Kingfisher Pond

DEC 1 1983  
 WATER RESOURCES DEPT.  
 SALEM, OREGON

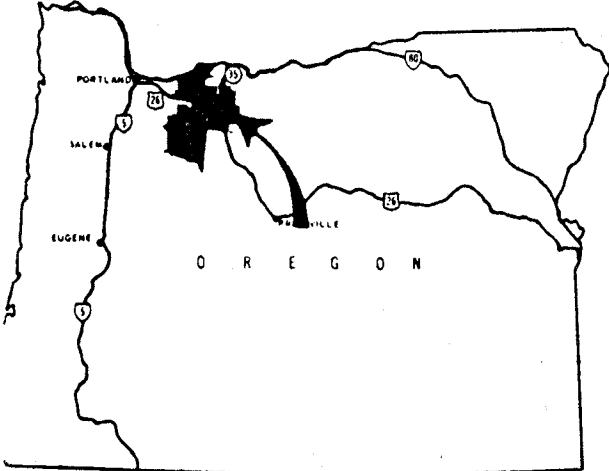

**Vicinity Map**

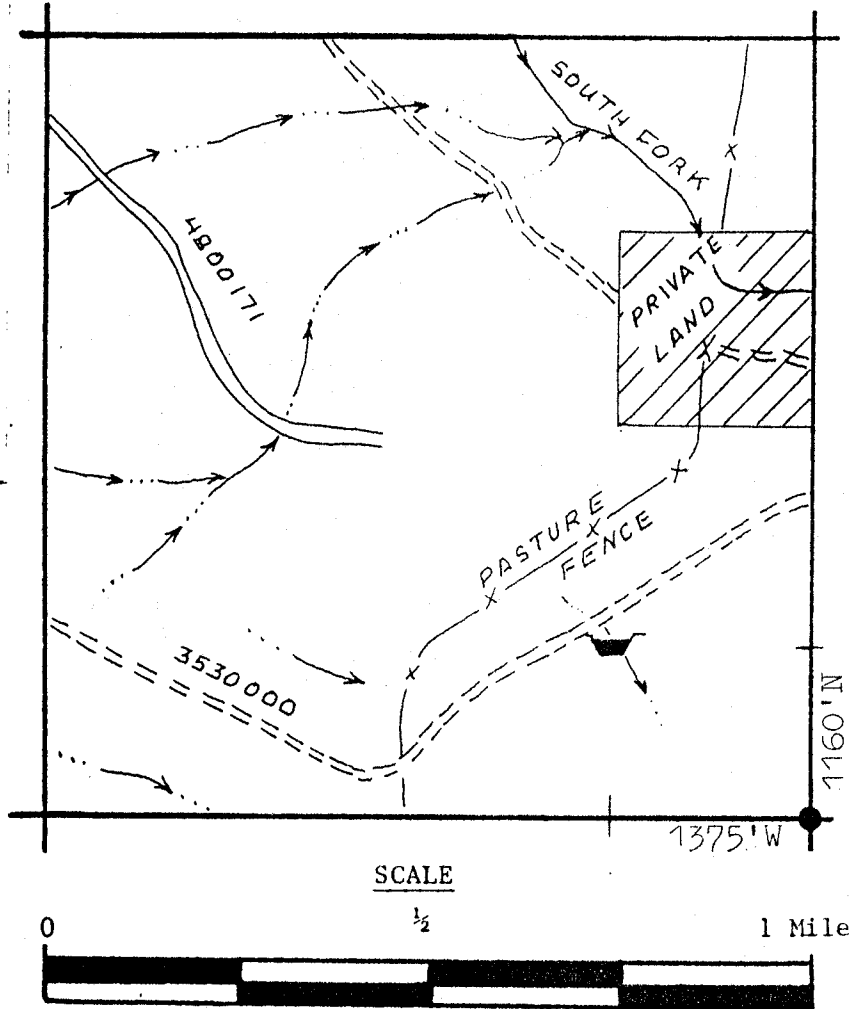

**RECEIVED**  
 DEC 1 1983  
 WATER RESOURCES DEPT.  
 SALEM, OREGON

TYPICAL DEVELOPMENT

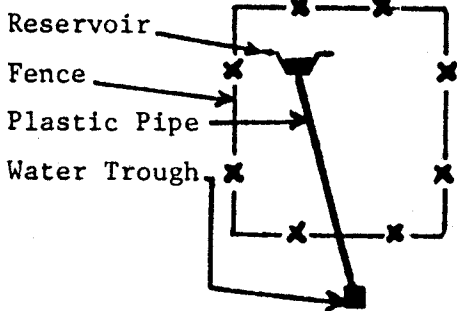

LEGEND

- Int. Stream
- Creek
- Flow Direction
- Reservoir
- Road
- Exclosure Fence

Application No. R-66042  
 Permit No. R 9885