

STATE OF OREGON WATER RESOURCES DEPARTMENT  
 APPLICATION FOR A PERMIT TO CONSTRUCT A RESERVOIR

APPLICANT: USDA FOREST SERVICE, MT. HOOD NATIONAL FOREST

Township 4S Range 11E Section 25

Reservoir (Pond) Name Snipe Pond

933  
 WATER RESOURCES DEPT.  
 SALEM, OREGON

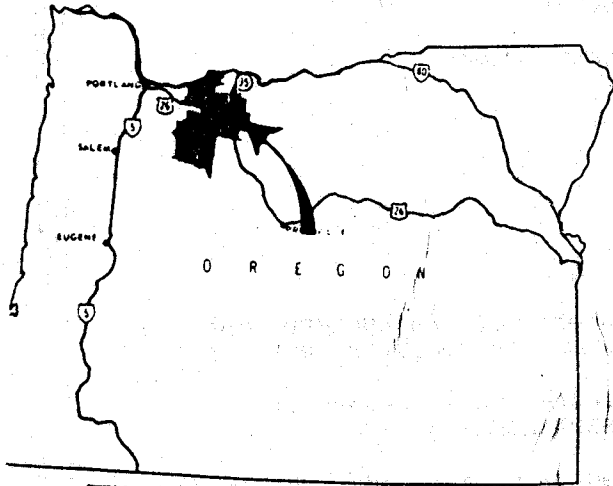

**Vicinity Map**

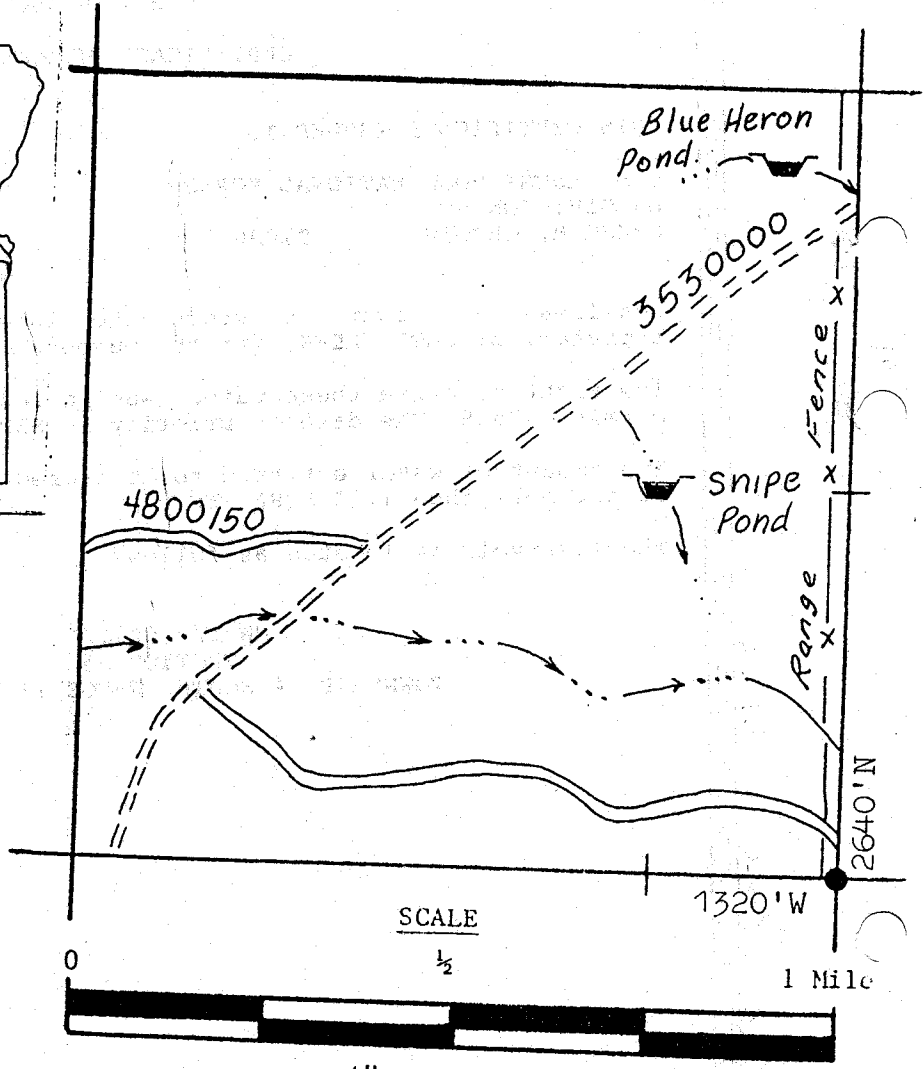

SCALE

1/2

1 Mile

4" to 1 mile

**RECEIVED**

DEC 1 1988

WATER RESOURCES DEPT.  
 SALEM, OREGON

TYPICAL DEVELOPMENT

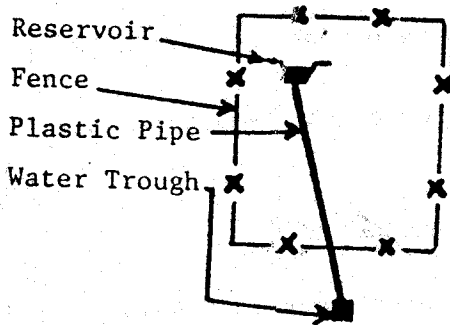

LEGEND

- Int. Stream
- Creek
- Flow Direction
- Reservoir
- Road
- Exclosure Fence

Application No. R-66045  
 Permit No. R 9888