

T. 4 S., R. 4 E., W.M.

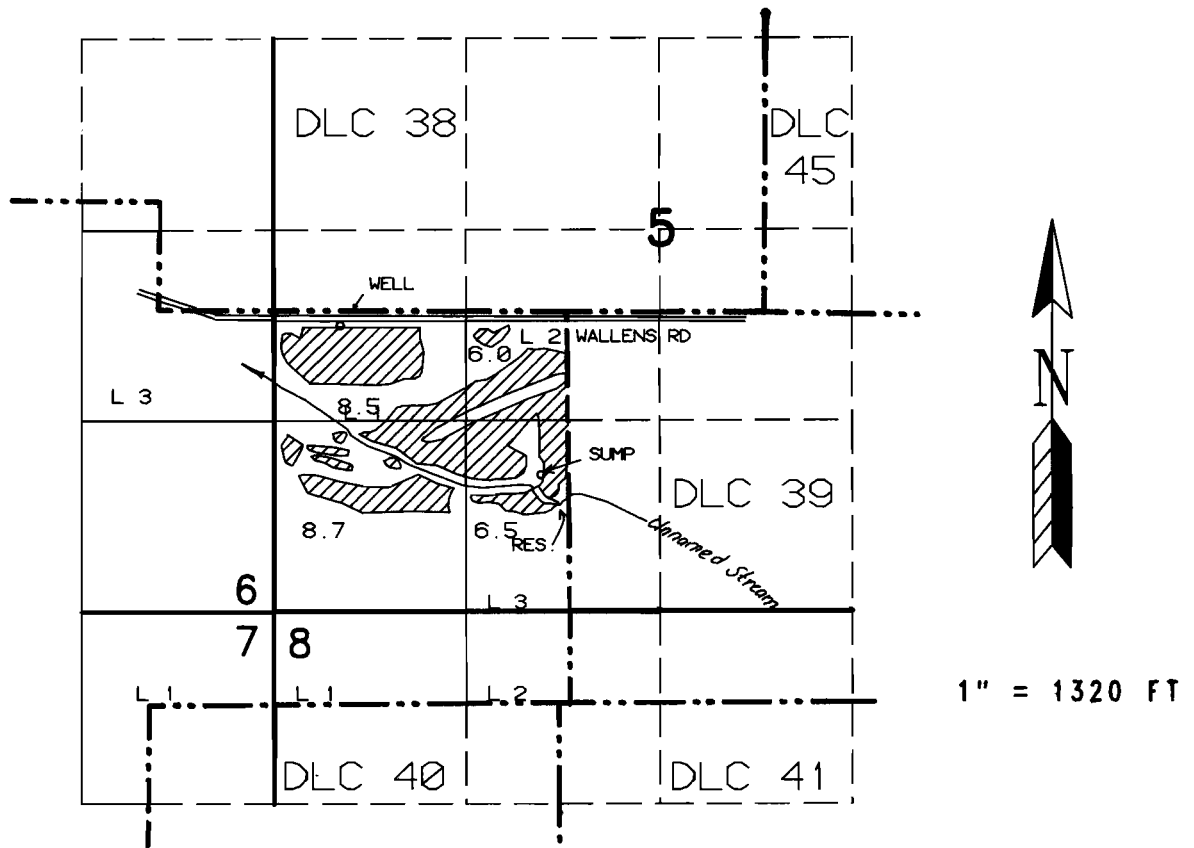

LOCATIONS MEASURED FROM THE NW COR. DLC 39
 RES. LOCATION: 1190 FT S AND 230 FT W
 WELL LOCATION: 100 FT S AND 1550 FT W
 SUMP LOCATION: 1110 FT S AND 190 FT W

FINAL PROOF SURVEY UNDER

Application No.: R-56926 Permit No.: R-6889
 G-8660 G-7952
 56928 42769

IN THE NAME OF

GREGORY L. HARTMAN

Surveyed: JULY 15, 1987

By: T. M. WARREN