

T. 23S., R. 30E., W. M.

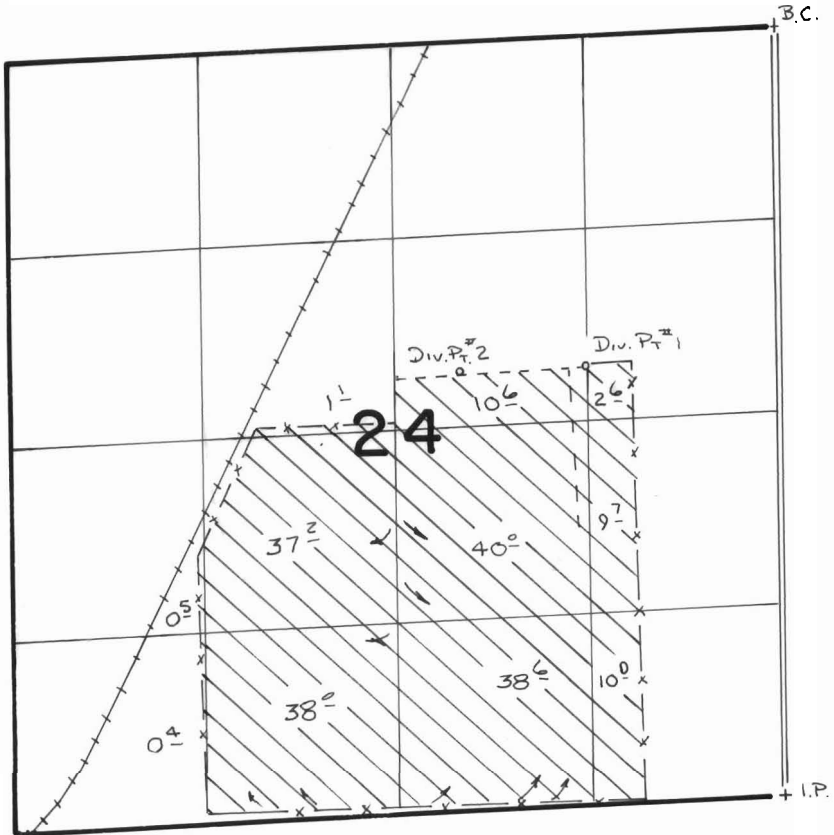
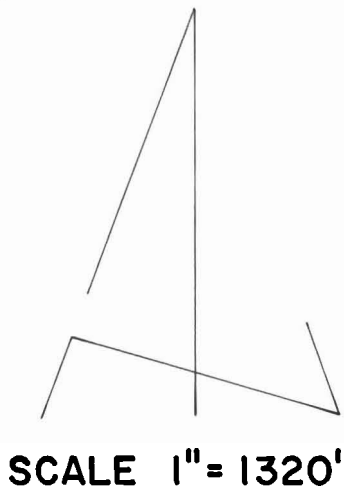

Div. Pt. #1 Loc: 3010'N. & 1330'W. }
 Div. Pt. #2 Loc: 3020'N. & 2190'W. } FROM SE COR. SEC. 24

FINAL PROOF SURVEY UNDER

Application No. **60074**. Permit No. **45057**...
 IN NAME OF

PETE CLEMENS

Surveyed **5-4** 19**88**, by **B. James**