

# T. 4N., R. 8W., W.M.

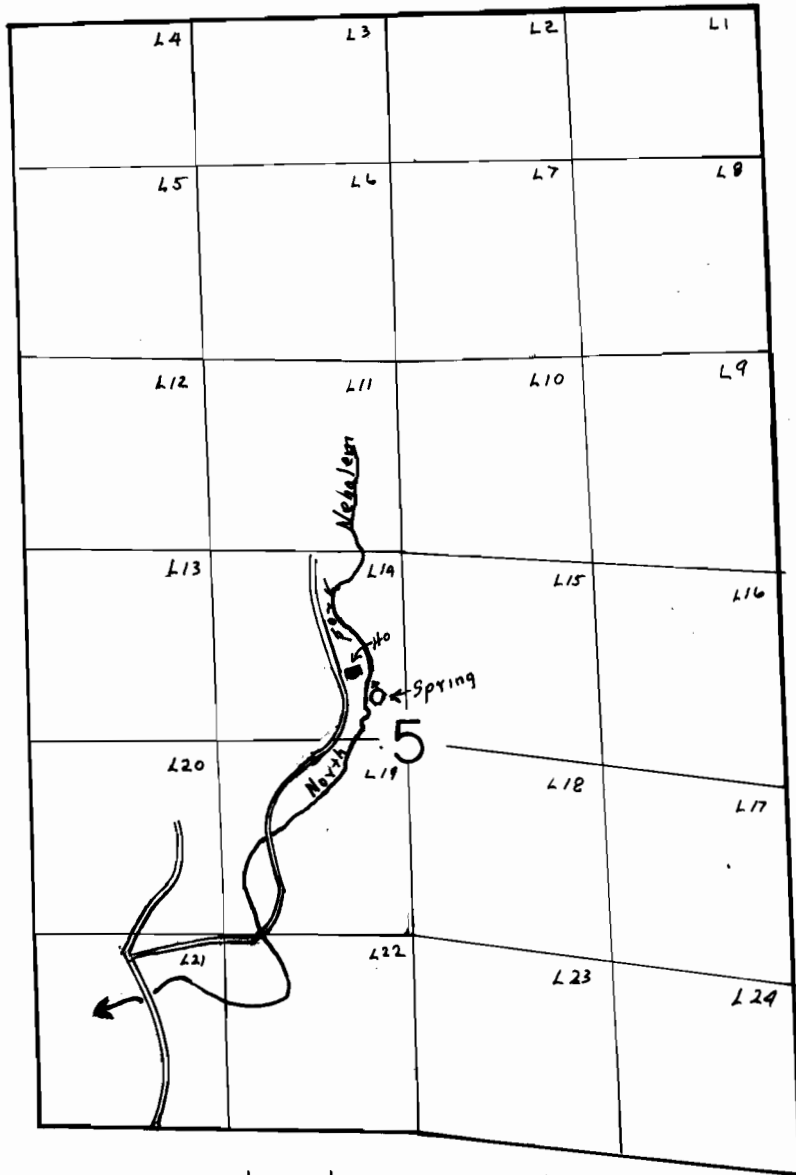

Spring Located 300' N & 1110' E From SW Corner Lot 14

SCALE: 1" = 1320'

## FINAL PROOF SURVEY UNDER

Application No. 66944..... Permit No. 48336.....

IN NAME OF

.....WILLIAM..... G..... KIRK.....

Surveyed JUNE 21... 1989., by J.M. WARREN.....