

T. 1S., R. 3W., W.M.

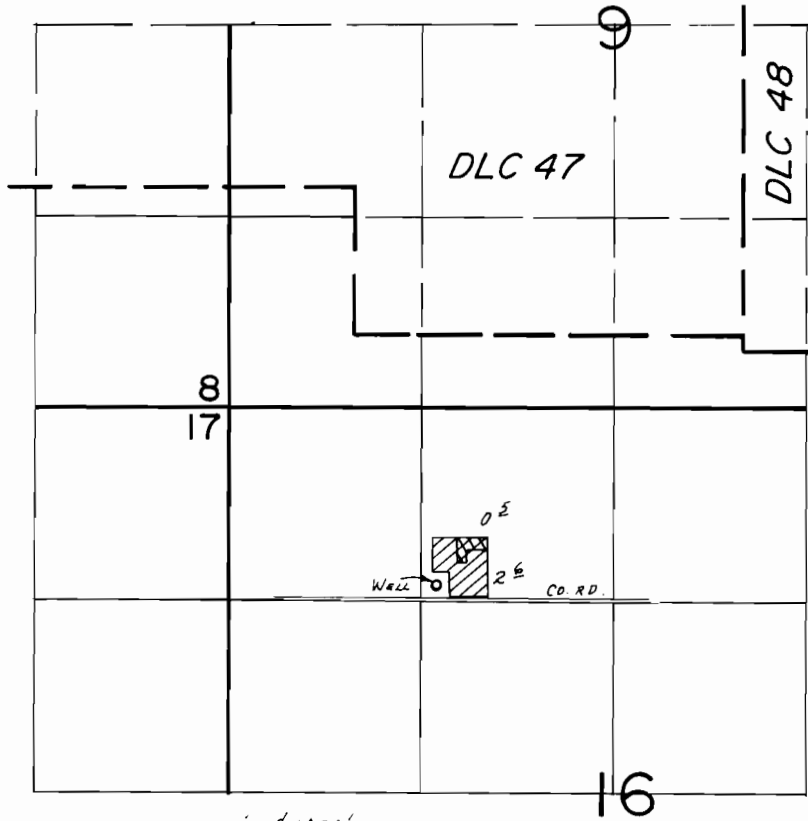

WELL LOC.: 1230' S. & 1420' E. FROM NW COR. SEC. 16.

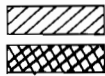

IRRIGATION

SCALE: 1" = 1320'

CONTAINERIZED NURSERY STOCK

FINAL PROOF SURVEY UNDER

Application No. G:10709 Permit No. G:9835.....
IN NAME OF

.....JOHN E. JACKSON, Jr.

Surveyed Aug. 12... 19.86, by B.W. BISHOP.....

11/2/87
RWB