

# T. 25 S., R. 7 W., W.M.

## SECTION 21

NE<sup>1</sup>/<sub>4</sub> NW<sup>1</sup>/<sub>4</sub>

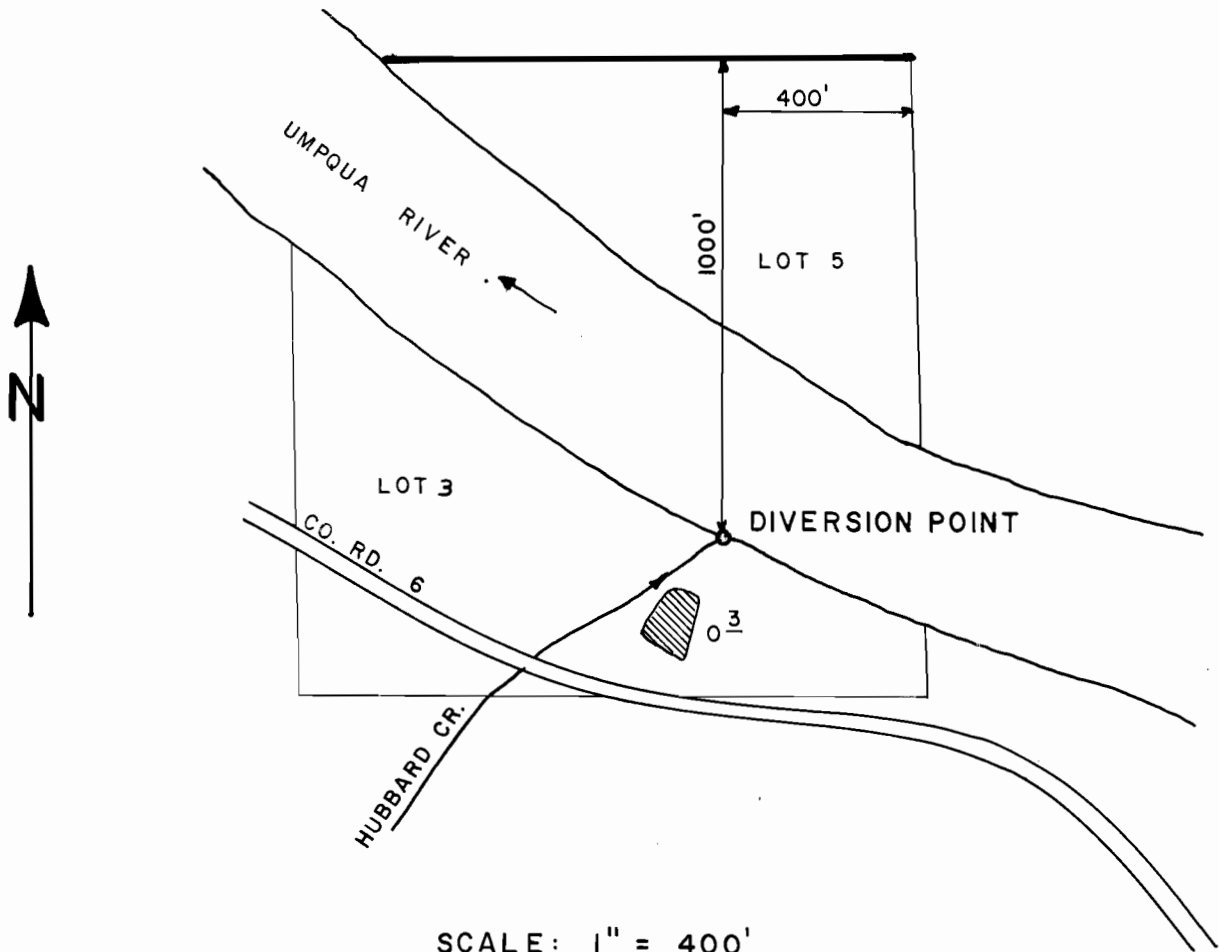

### FINAL PROOF SURVEY UNDER

Application No. 63484 Permit No. 47761  
IN NAME OF

CARL M. FULLEN

Surveyed AUG. 6, 1986, by J.M. SCHMORDE