

T. 1 N., R. 4 W., W.M.

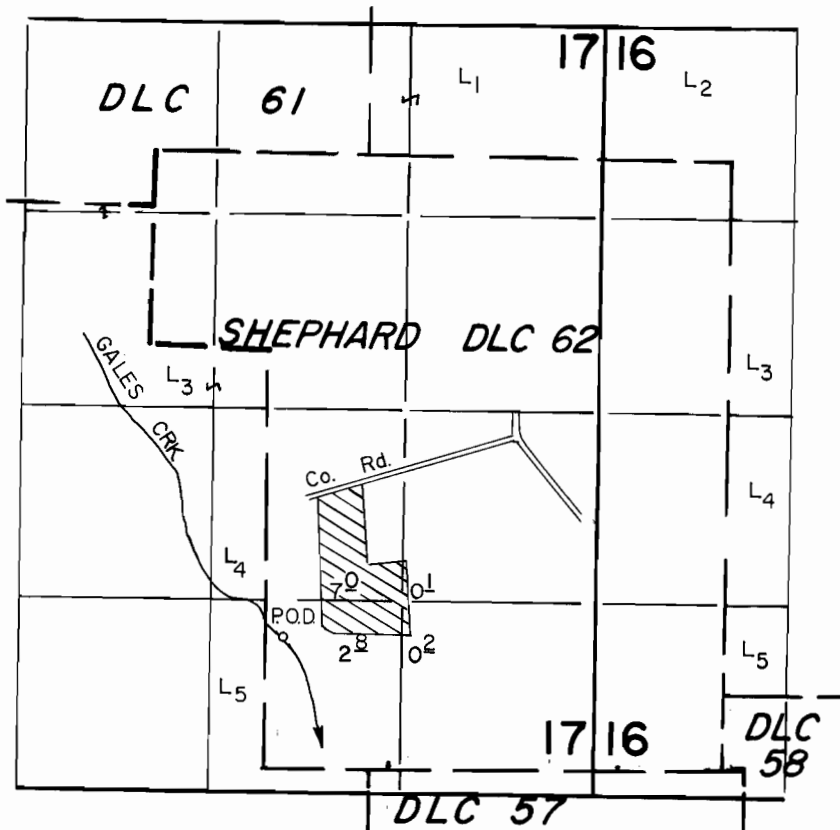

P.O.D. Loc. : 900' N. & 130' E. from SW Cor. DLC 62

Scale : 1" = 1320'

FINAL PROOF SURVEY UNDER

Application No. 63494 Permit No. 47360
IN NAME OF

PAUL KEEN, dba FRECARPAU INVESTMENT CO.

Surveyed AUG. 9. 1988, by T. Warren