

RECEIVED

SEP 11 1981

WATER RESOURCES DEPT
SALEM, OREGON

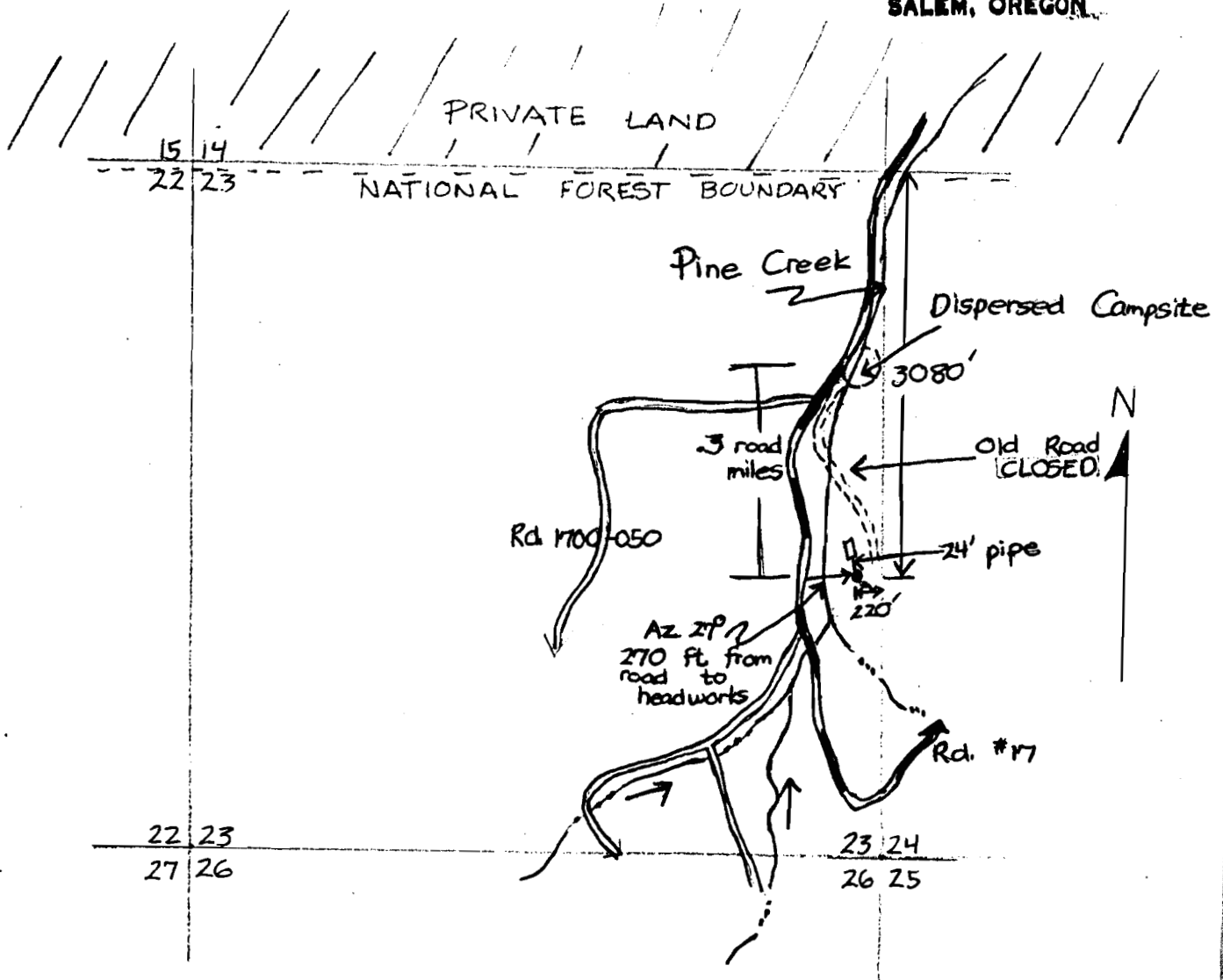

OLE SPRING

Spring Located: 3080 ft. S. and 220 ft. W. from the NE corner Section 23

T17S, R19E, Sec. 23, NE 1/4, SW 1/4

Scale : 4 inches = 1 mile

Application No. 62731

Permit No. 48664

Cert. 63875

RECEIVED

DATE 2-28-90

WATER MASTER DISTRICT #11

BY JMY

48664