

STATE OF OREGON WATER RESOURCES DEPARTMENT  
 APPLICATION FOR PERMIT TO APPROPRIATE SURFACE WATER

APPLICANT: USDA FOREST SERVICE, MT. HOOD NATIONAL FOREST

Township 3S Range 11E Section 2

Spring Name Elk

RECEIVED

NOV 4 1981

WATER RESOURCES DEPT  
 SALMON, OREGON

Application No. 63016  
 Permit No. 48727

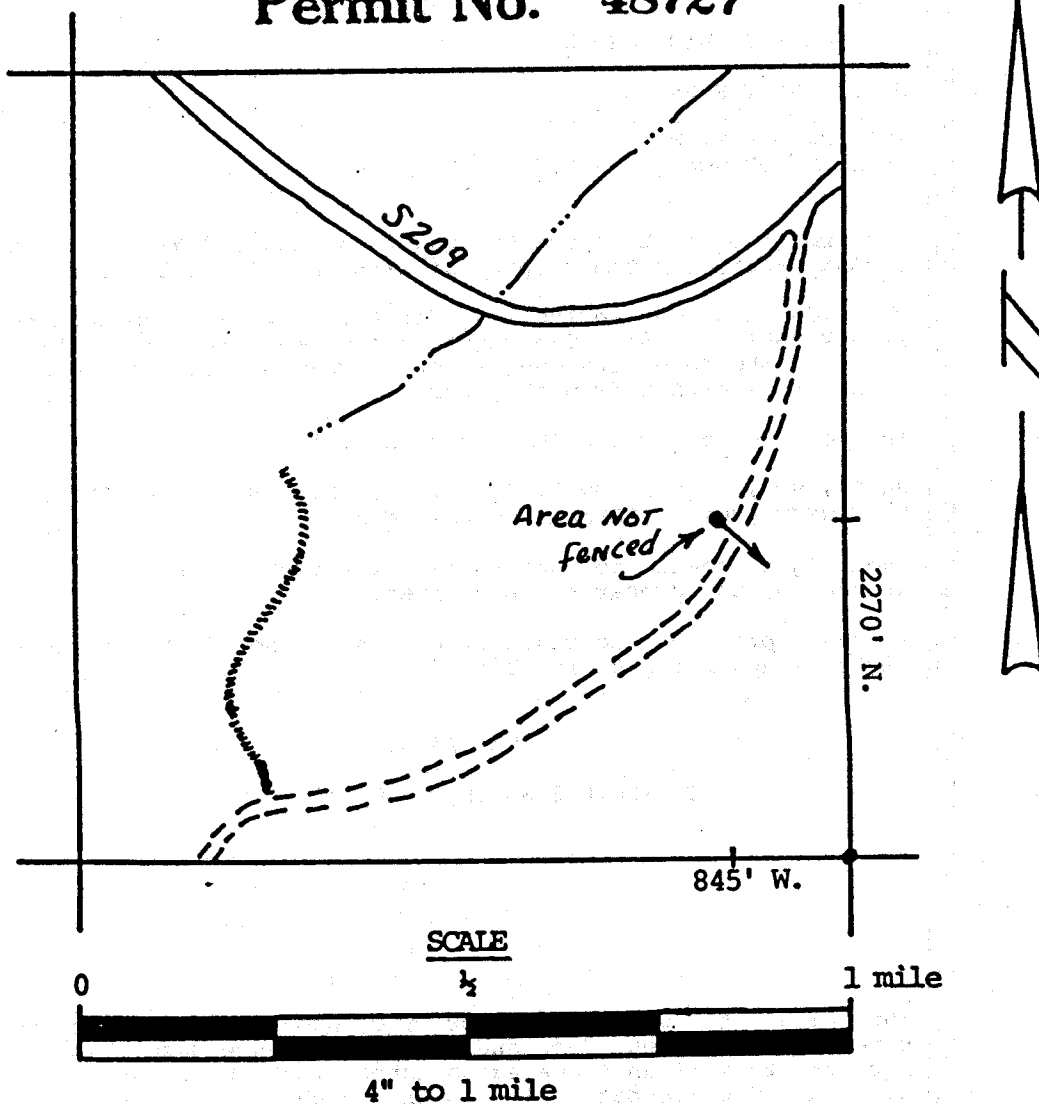

TYPICAL DEVELOPMENT

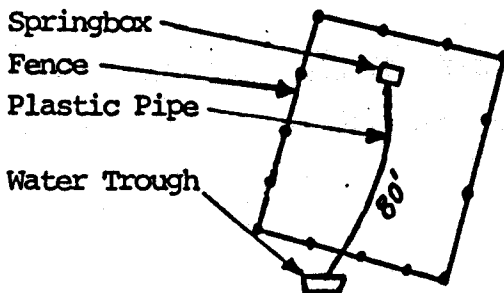

LEGEND

- Int. Stream     ....
- Creek            ———→
- Spring & Direction  
of Flow         ●→
- Road              = = =
- Pasture Fence   x — x —

Area Enclosed: Approximately 1 acre.