

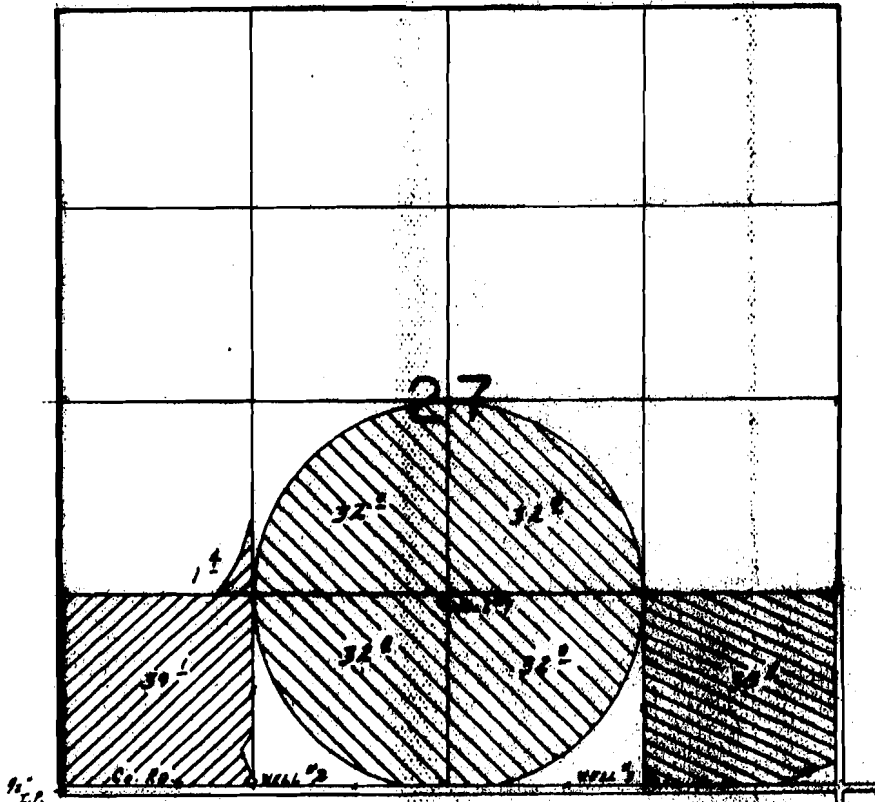



T. 14 S., R. 12 E., W. M.



WELLS LOC.: #1-1200' N. & 2620' E., #2-50' N. & 1300' E., #3-60' N. & 4850' E., ALL FROM SW COR. SEC. 27.

-  Permit G-9342
 -  Permit G-9730
 -  Permit G-9787
- SCALE: 1" = 1320'

FINAL PROOF SURVEY UNDER

Application No. G-10297 Permit No. G-9787 - Cert. 64035
G-10615 G-9730
IN NAME OF

DAN H. HEIERMAN

Surveyed May 18, 1988, by B.W. BISHOP

RECEIVED
DATE 2-28-90
WATER MASTER DISTRICT #11
BY *ms*

G-9787
11/15/00 *and*