

# T.5 & 6S., R.8W., W. M.

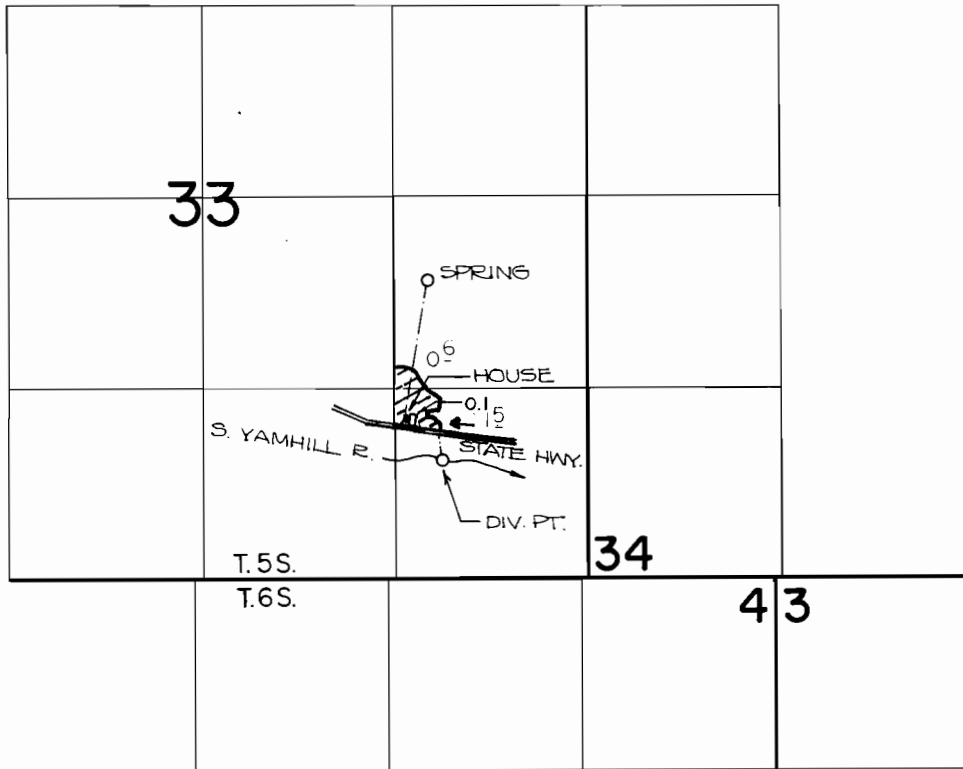

SPRING LOCATION: 2050 FT. N. AND 1100 FT. W.; DIV. PT.  
 LOCATION: 800 FT. N. AND 990 FT. W. BOTH FROM  
 THE S.E. CORNER OF SECTION 33.

## FINAL PROOF SURVEY UNDER



Application No. 52925... Permit No. 40297.....  
 IN NAME OF

SCALE: 4" = 1 MILE

TRAVIS C. & HAZEL C. DICKSON

Surveyed NOV. 16... 1984, by P. Patten