

T.34S., R.5W., W.M.

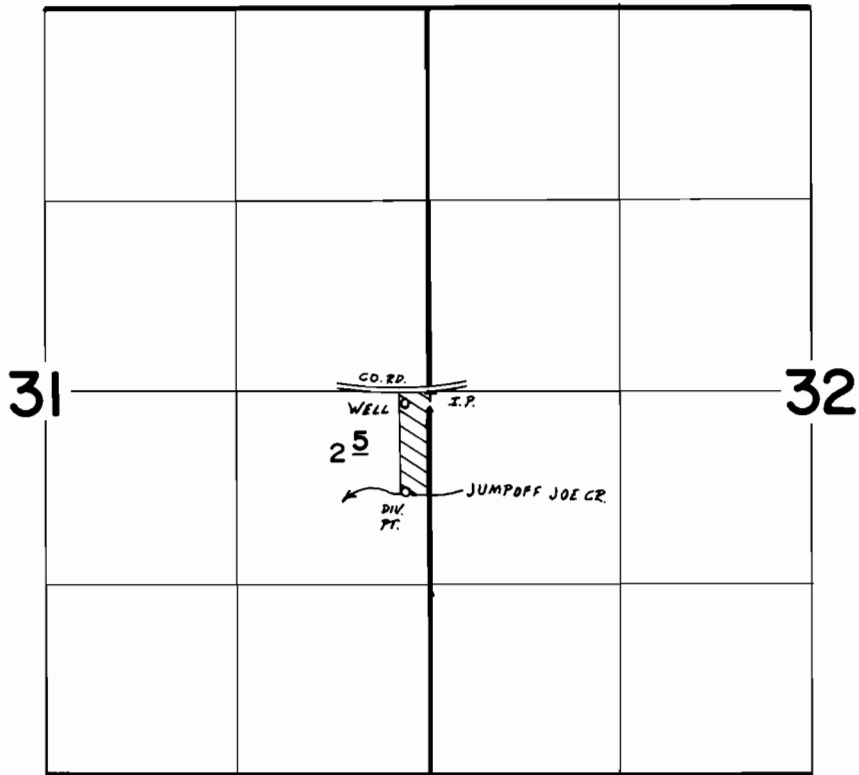

SCALE 1" = 1320'

DIV. PT.: 700'S & 180'W FROM E 1/4 COR. SEC. 31.

WELL: 60'S & 180'W FROM E 1/4 COR. SEC. 31.

FINAL PROOF SURVEY

UNDER

64624

47345

Application No. G-10862 Permit No. G-10011....

IN NAME OF

..... IRVING W. JOHNSON

Surveyed JULY 12, 1984, by B.S. JAMES.....