

# T.9S., R.40E., W.M.

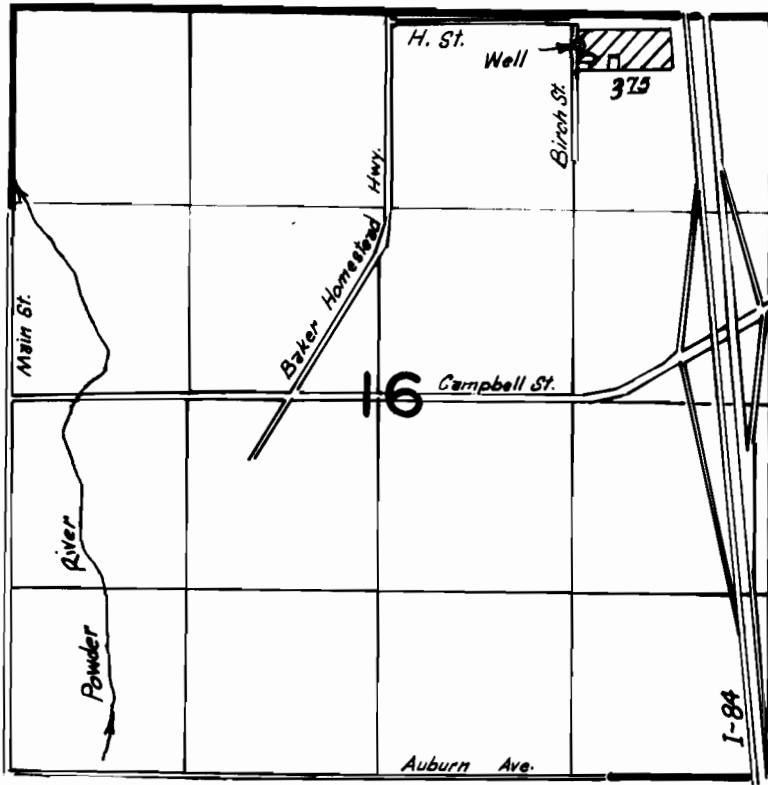

The location of the well is 190' S. & 1320' W.  
from the NE cor. sec. 16.



Scale: 1" = 1320'

## FINAL PROOF SURVEY UNDER

Application No. G11386 Permit No. G10527  
IN NAME OF

HUGH & SUE HARRIS

Surveyed 9-30 1987, by Vern Church