

43461  
64154

# T.38S., R.8E., W.M.

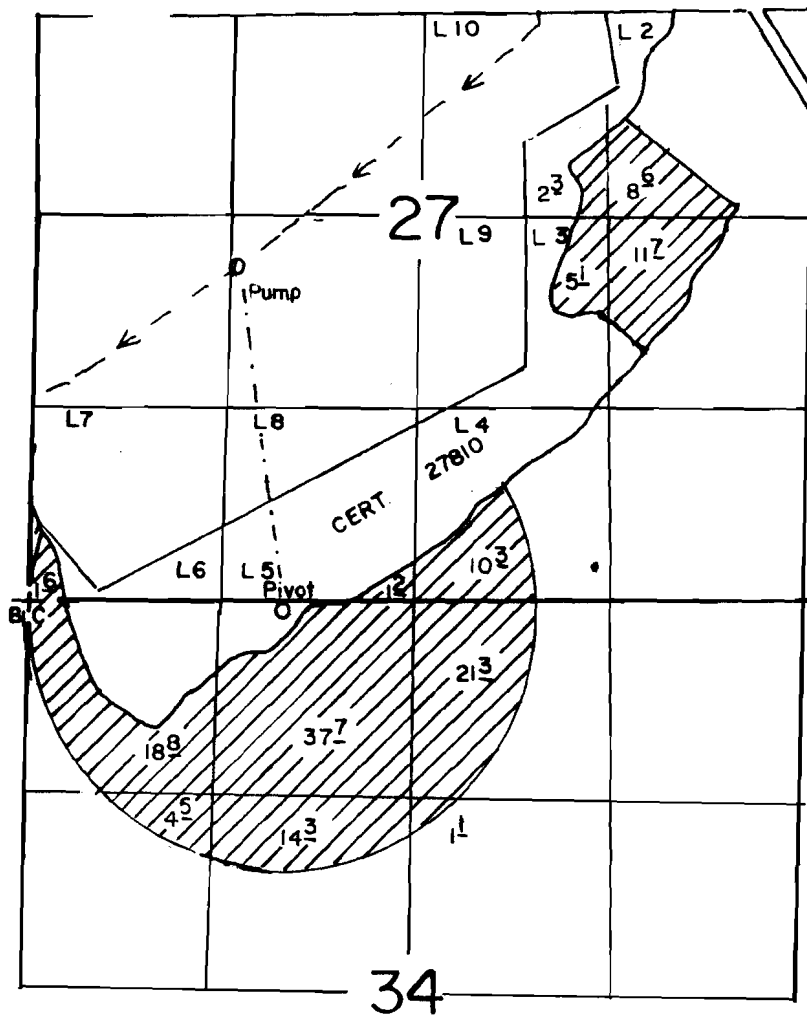

## FINAL PROOF SURVEY UNDER

T38S R8E WM  
Sec 7

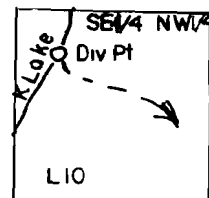

Div Pt Loc 1000' N & 1600' E  
From The NW 1/4 Cor Of Sec 7

Application No. 57677 Permit No. 43461  
IN NAME OF

D. D. LAND CO.

Surveyed JUNE 15, 1989, by B. W. BISHOP