

T.16S., R.18E., W.M.

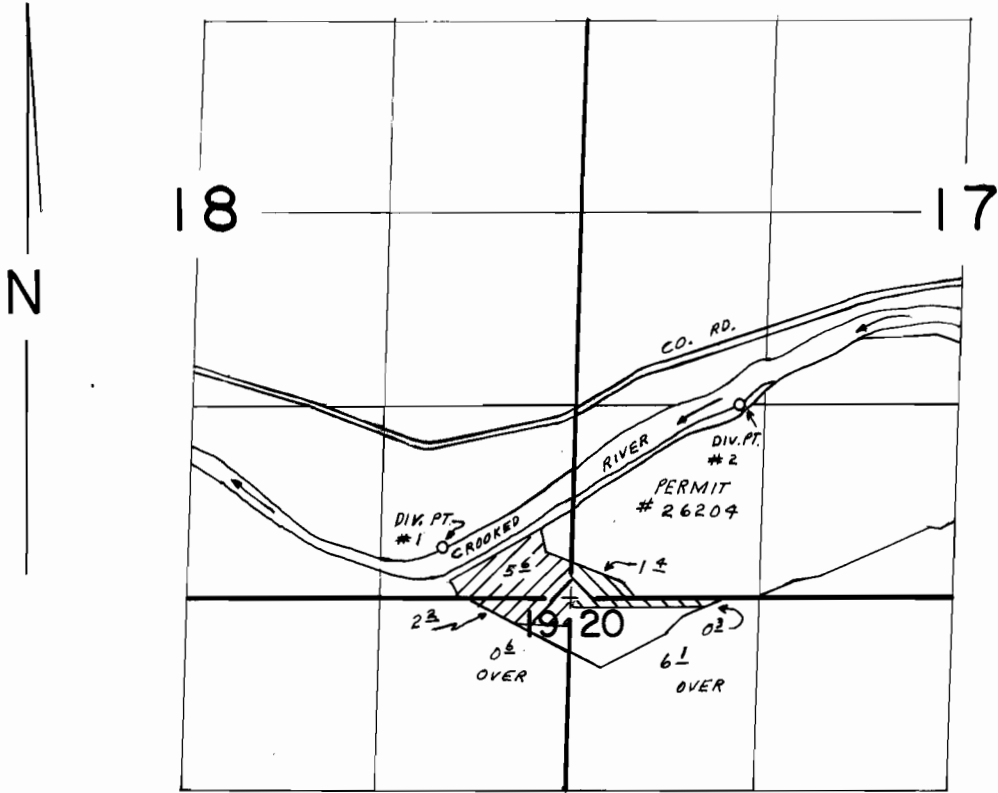

DIV. PT. #1 LOC. 330' N. & 920' W. FROM THE SE COR. OF SEC. 18  
DIV. PT. #2 LOC. 1300' N & 1140' E. FROM THE SE COR. OF SEC. 18

SCALE: 1"=1320'

**FINAL PROOF SURVEY**  
UNDER

TRANSFER 4971  
64062 47100  
Application No. 64063 Permit No. 47101  
IN NAME OF

W. JAMESON & S. JAQUAY et al.

Surveyed AUG...4... 1988, by B. BISHOP.....