

T.4S., R.3&4 W., W.M.

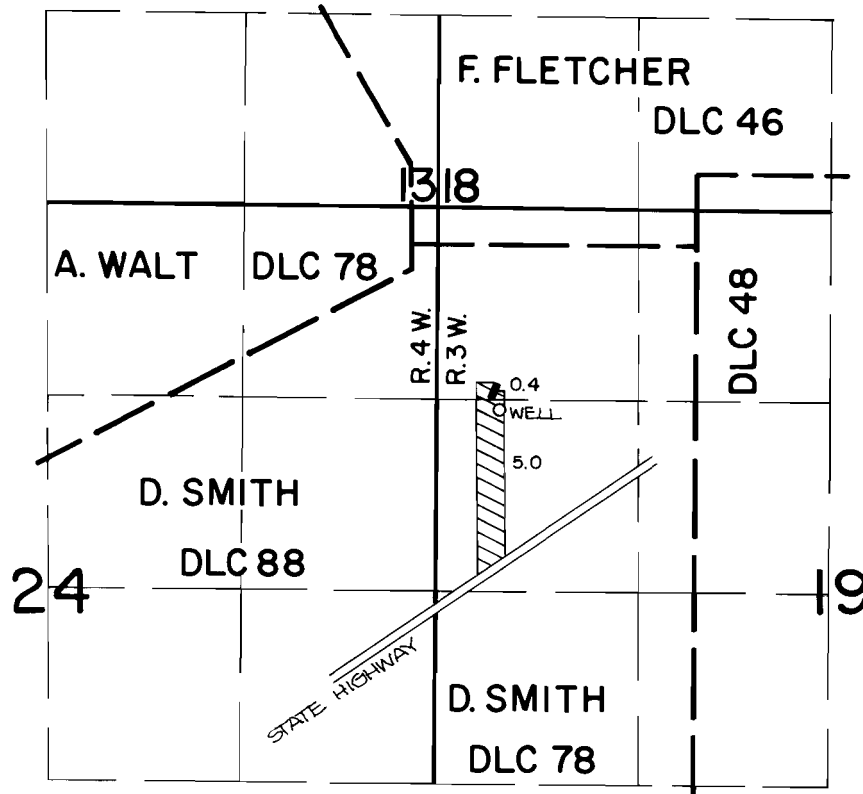

WELL LOCATION: 1110 FT. S. AND 1330 FT. W. FROM THE N.E. CORNER OF THE D. SMITH DLC NO. 78

FINAL PROOF SURVEY
UNDER

SCALE: 4" = 1 MILE

Application No. G-9719... Permit No. G-9536...
IN NAME OF

...JAMES...ALLEN...WILLIAMSON...

Surveyed MAY 17, 1984, by P. Pagter...