

T.2N, R.2W, W.M.

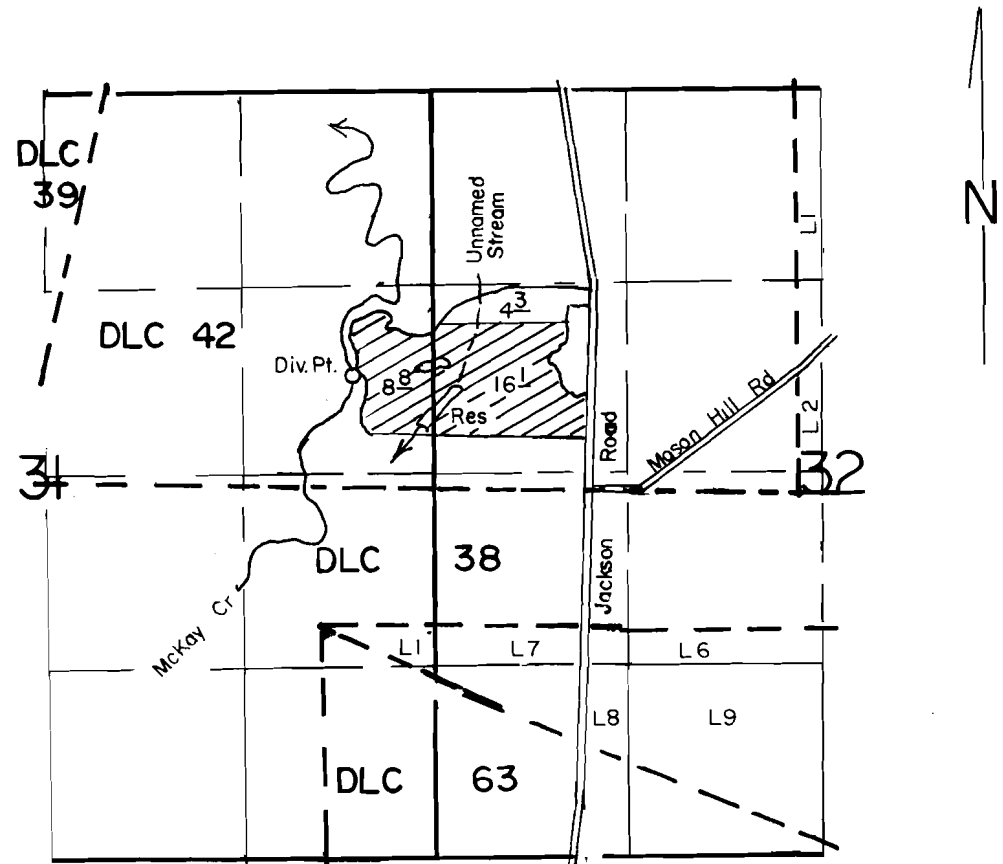

Div Pt Loc 700' N & 550', Res Loc 300' N & 100' W, Both From The E 1/4 Corner Of Section 31

SCALE: 1" = 1320'

FINAL PROOF SURVEY UNDER

R-61911 R-8529
 61912 47146
 Application No. 55611..... Permit No. 41667.....
 IN NAME OF

.....GORDON E. HOFFMAN.....

Surveyed JUNE 6..... 1989., by J.M. WARREN.....