

T. 14 S., R. 12 E., W. M.

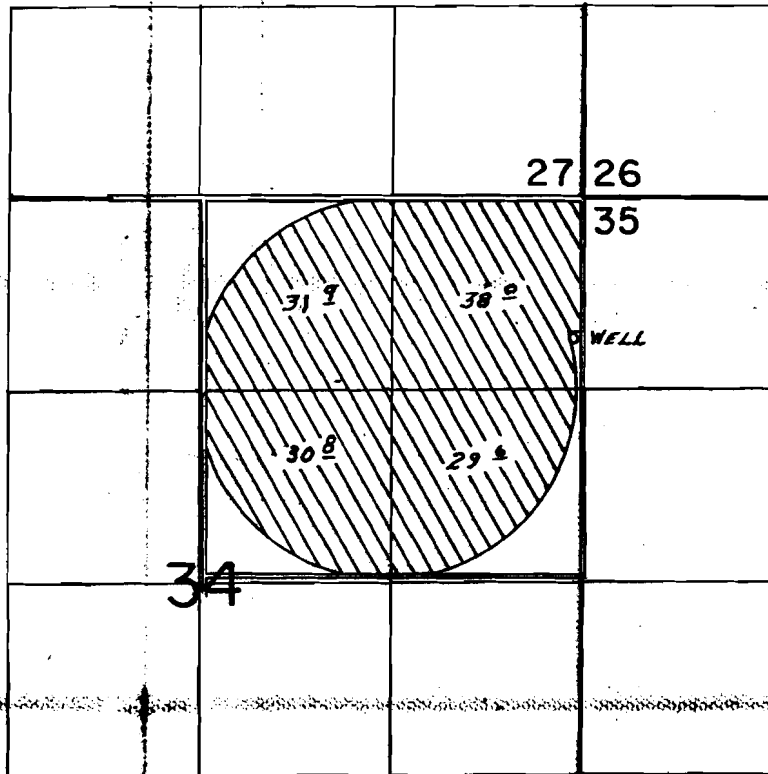

WELL LOC. 950 S. & 60 W. FROM NE COR. SEC. 34.

SCALE: 1" = 1320'

FINAL PROOF SURVEY
UNDER

Application No. G-9903... Permit No. G-9510...
IN NAME OF

Cert. # 64338

...JOHN A. & MILDRED L. CHOTARD...

Surveyed Apr. 27... 19.88., by B. W. BISHOP...

11# 8MS WPA# 11
REC'D 9-24-90 5MS WPA# 11

11/5/88 GWS

PTS 11-1988

G-9510