

T.17&18S.,R.47E.,W.M.

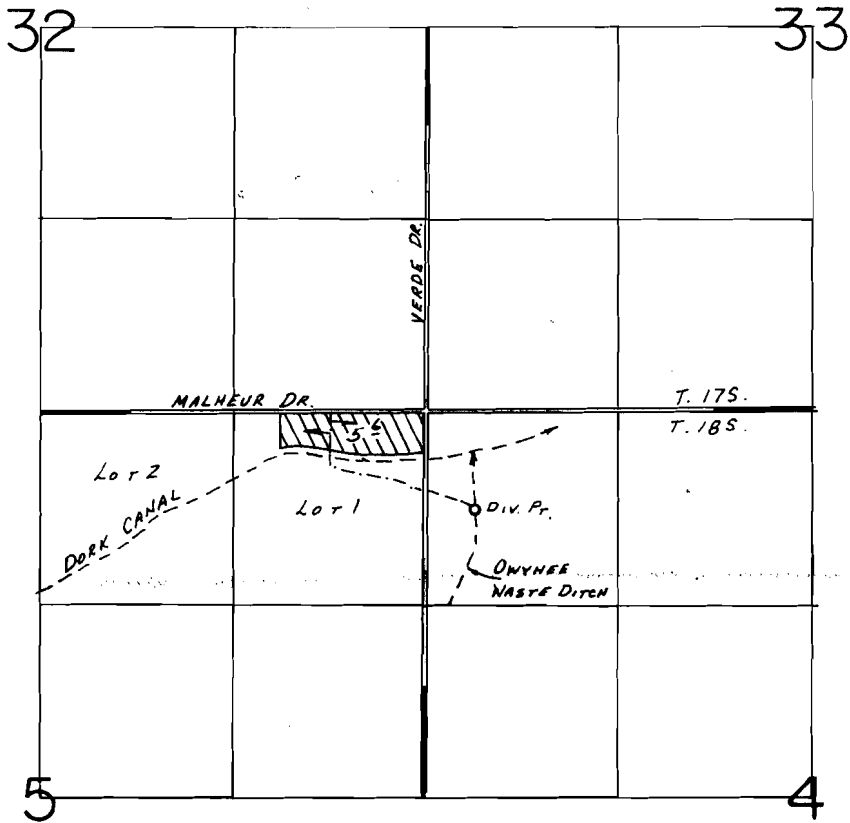

DIV. PT. LOC.: 670'S. & 340'E FROM NW COR. SEC. 4.

SCALE: 1"=1320'

FINAL PROOF SURVEY UNDER

Application No. 62413... Permit No. 47025.....
IN NAME OF

.....B. LONNIE WARD.....

Surveyed Mar. 25. 1986., by L.M. TOLL.....

3/6/87
BBC-1N-84